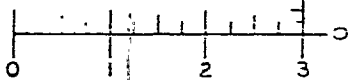

TABLE OF CONTENTS

PLATE NO	QTY FR	TITLE	PLATE NO	QTY FR	TITLE
1	1	COVER PAGE	10	3	01 LEVEL FWD, MIDBODY, AFT
2	1	COMPARTMENTATION DIRECTORY	11	3	MAIN DECK FWD, MIDBODY, AFT
3	1	GENERAL DIMENSIONS AND DATA	12	2	CHAIN LOCKER FLAT ANB
4	3	OUTED PROFILE FWD, MIDBODY, AFT			FIRST PLATFORM FWD AND AFT
5	3	INBD PROFILE FWD, MIDBODY, AFT	13	1	30'-0" V.L. AND 21'-6" WL AFT
6	1	07 LEVEL	14	1	21'-6" V.L. FWD AND 17'-6" WL
7	1	06 & 05 LEVELS	15	3	6'-0" WL FWD, MIDBODY, AFT & 9'-0" WL MIDBODY
8	1	04 & 03 LEVELS	16	1	DOUBLE BOTTOM
9	2	02 LEVEL FWD, MIDBODY, AFT	17	1	MIDSHIP AND TYP SECTS.



CORRECTED TO SUIT SHIP

REVISION	PLACE	APPROVAL SIGNATURE	DATE

THIS DRAWING IS APPLICABLE TO THE
AO177 JUMBO CLASS
 HULLS 177, 178 & 179
 STARTING WITH REV. -
 CONTRACT NO. N00024-88C-2221
 AVONDALE JOB NO. C8-280

DISTRIBUTION LIMITED TO U. S. GOV'T.
 AGENCIES ONLY, (TEST & EVALUATION)
 () REQUESTS FOR
 THIS DOCUMENT MUST BE REFERRED
 TO THE COMMANDER, NAVAL SEA SYS.
 COMMAND.

***AO177 CIMMARRON**
AO178 MONONGAHELA
AO179 MERRIMACK

ASI JOB NO
C6-850

AO

CONTRACT NO
 N00024-76-C-2080

 **AVONDALE SHIPYARDS, INC**
 P O BOX 50280 NEW ORLEANS LA 70150

DRAWN BY
 F.M. DATE 11-7-79

AO-177 CLASS *
BOOKLET OF GEN DWGS
 AO

CHECKED BY
 F.B. DATE 11-7-79

APVD
B.J. Puffer 11-7-79

APVD

BKLT GEN DWG AO179 MERMCK

SIZE CODE IDENT NO NAVSEA DWG NO REY
H 53711 801 5183615

NAVY APVD

SCALE 1/8"=1'-0" ASI NO C6-850 01-03-03 PLATE 1 FRI OF 1

A. ACCESS TRUNK 4-5CE-2-T
 AC MCHRY RM 1-5CE-1-E
 AUX MCHRY RM 1-5DB-1-E
 AUX PUMP RM ACCESS TRUNK 3-5CE-2-T
 AFFF STATION 1-47-2-Q
 AFFF STATION 1-61-1-Q
 AFFF STATION 1-129-2-Q
 AFT FLMB LIQUID ISSUE RM 1-118-1-X
 AFT PEAK TANK 3-112-0-W
 AFT REPAIR NO 3 1-114-3-Q
 AIR COND AND REFRIGERATION MCHRY RM 2-53-2-E
 ARMORY 2-112-4-Q
 AUTO COMB CONT SHOP 2-53-4-Q
 AFT ELECTRICAL STRM 2-112-0-A
 AUX PUMP RM 4-5CD-0-Q

B. BARBER SHOP 2-94-0-Q
 BATH 02-63-4-L
 BATH 02-75-1-L
 BATH 02-76-2-L
 BATH 02-73-1-L
 BATH 02-63-3-L
 BATH 03-62-3-L
 BATH 03-82-4-L
 BATH 03-62-5-L
 BATH 03-62-6-L
 BATH 03-63-1-L
 BATH 03-63-2-L
 BATH 03-74-1-L
 BATH 03-74-2-L
 BATH 03-73-1-L
 BATH 03-73-2-L
 BATH 04-62-1-L
 BATH 04-68-2-L
 BATH 04-68-4-L
 BATH 05-62-1-L
 BOSM STRM 1-112-4-A
 BOSM WORKSHOP & STRM 1-R-0-A
 BRIDGE BR WC (CONTINUED ON PLT 2 - FR 2 OF 2) 08-77-2-L

C. CWS AMMO TRUNK 01-28-4-T
 CWS AMMO TRUNK 03-99-2-T
 CWS LOCAL CONTROL RM NO 1 02-27-0-C
 CWS LOCAL CONTROL RM NO 2 03-94-0-C
 CWS MAG NO 1 01-28-2-M

CWS MAG NO 2 01-28-2-M
 CWS STRM B ACFSHCP NO 1 01-28-1-Q
 CWS STRM B ACFSHCP NO 2 02-94-0-Q
 CARGO FUEL CONTROL CENTER 2-4-1-E
 CARGO GAS CYL STRM (INERT) NO. 1 01-25-3-AA
 CARGO GAS CYL STRM (OXYGEN & INERT) 01-30-2-AA
 CARGO GAS CYL STRM (INERT) NO. 2 01-31-2-AA
 CARGO GAS CYL STRM (FLAMMABLE) 01-32-2-AA
 CARGO JP-5 TANK 4-50F-0-JJ
 CARGO JP-5 TANK 4-37-0-JJ
 CARGO JP-5 TANK 4-41-0-JJ
 CARGO JP-5 TANK 4-33-0-FF
 CARGO OIL OR CARGO JP-5 TANK 4-50I-0-FF
 CARGO JP-5 OR SETTLING TANK 4-41-0-JJ
 CARGO OIL OR CARGO JP-5 TANK 4-48-0-FF
 CARGO OIL OR CARGO JP-5 TANK 4-54-0-FF
 CARGO OIL OR SETTLING TANK 4-58-0-FF
 CARGO OIL TANK 4-29-1-FF
 CARGO OIL TANK 4-23-2-FF
 CARGO OIL TANK 4-33-2-FF
 CARGO OIL TANK 4-33-3-FF
 CARGO OIL TANK 4-50-1-FF
 CARGO OIL TANK 4-50-2-FF
 CARGO OIL TANK 4-41-1-FF
 CARGO OIL TANK 4-54-1-FF
 CARGO OIL TANK 4-54-2-FF
 CARGO STRM FLMB MATERIAL 01-34-6-X
 CARGO STRM FLEET FRT 01-97-2-AA
 CARGO STRM NO. 1 (LUBO OR FLEET FRT) 01-28-3-AA
 CARGO STRM NO. 2 (LUBO OR FLEET FRT) 01-31-1-AA
 CARGO TANK CLEANING EQPT STWG COMPT 1-45-3-A
 CARGO TANK CLEANING EQPT STWG COMPT 1-45-4-A
 CCTV/ENTERTAINMENT RM 1-62-3-Q
 CHAIN LOCKER 3-24-1-0
 CHAIN LOCKER 3-24-2-Q
 CHART ROOM 08-68-1-C
 CHEM WARF DEF EQUIP STRM 2-112-2-A
 CHILL STRM 01-60-5-A
 CHT TANK 3-78-4-W
 CARGO OIL TANK 4-41-2-FF
 CARGO OIL TANK 4-50F-1-FF
 CARGO OIL TANK 4-50F-2-FF
 CARGO OIL TANK 4-50I-1-FF
 CARGO OIL TANK 4-50I-2-FF

CARGO ORDNANCE HOLD 2-50-0-AA
 CARGO ORDNANCE HOLD 3-50-0-AA
 CARGO ORDNANCE HOLD 4-50-01-AA
 CARGO WEAPONS ELEVATOR 4-50B-2-T
 CARGO WHITE PHOS MAGAZINE 1-50F-2-M
 CLEAN BALLAST TANK 3-102-1-W
 CLEAN BALLAST TANK 3-102-2-W
 CLEAN BALLAST TANK 4-18-0-W
 CLEAN BALLAST TANK 4-25-1-W
 CLEAN BALLAST TANK 4-25-2-W
 CLEAN BALLAST TANK 4-54-3-W
 CLEAN BALLAST TANK 4-54-4-W
 COFFERDAM 4-71-0-Y
 COFFERDAM 4-75-0-Y
 CO2 TRANSFER SHOP 1-45-6-Q
 COMBAT INFORMATION CENTER 05-74-2-C
 COMMANDING OFFICER CABIN 05-62-0-L
 COMMANDING OFFICER STRM 05-62-3-A
 COMMANDING OFFICER STATEROOM 05-68-1-L
 COMMUNICATION CENTER 04-75-0-C
 CONTAM CARGO JP-5 CLTG TANK 4-45-1-JJ
 CONTAM CARGO OIL CLTG TANK 2-60-1-FF
 CONTAMINATED OIL SETTLING TANK 3-38-2-F
 CPO BAGGAGE STOREROOM 02-80-2-A
 CPO LOUNGE 02-73-0-L
 CPO MESSROOM 01-64-0-L
 CPO STATEROOM 02-63-6-L
 CPO STATEROOM 02-73-1-L
 CPO STATEROOM 02-67-1-L
 CPO STATEROOM 02-73-1-L
 CREW BAGGAGE STRM 2-117-3-A
 CREW BERTHING & DRESSING NO. 1 1-68-4-L
 CREW BERTHING & DRESSING NO. 2 1-82-3-L
 CREW BERTHING & DRESSING NO. 3 1-82-6-L
 CREW BERTHING & DRESSING NO. 4 1-34-3-L
 CREW BERTHING & DRESSING NO. 5 1-94-2-L
 CREW BERTHING & DRESSING NO. 6 2-84-0-L
 CREW LOUNGE NO. 1 1-82-4-L
 CREW LOUNGE NO. 2 1-30-3-L
 CREW LOUNGE NO. 3 1-102-1-L
 CREW LOUNGE NO. 4 1-102-1-L
 CREW LOUNGE NO. 5 1-103-2-L

CREW LOUNGE NO. 6 2-100-2-L
 CREW MESSROOM 01-82-1-L
 CREW SANITARY SPACE NO. 1 1-68-2-L
 CREW SANITARY SPACE NO. 2 1-30-1-L
 CREW SANITARY SPACE NO. 3 1-82-4-L
 CREW SANITARY SPACE NO. 4 1-36-1-L
 CREW SANITARY SPACE NO. 5 1-38-2-L
 CREW SANITARY SPACE NO. 6 2-100-0-L
 CREW SERVING ANNEX 01-78-0-Q
 CREW TRAINING RM & LIBRARY 1-60-6-Q
 CMAA OFFICE 2-94-1-Q
 DAMAGE CONTROL CENTRAL 1-79-1-C
 DECK GEAR LXR 1-27-5-A
 DECK GEAR LXR 1-68-5-A
 DECK GEAR LXR 01-45-1-A
 DECK GEAR LXR 01-45-2-A
 DECK GEAR LXR 02-62-4-A
 DECK GEAR LXR 01-50H-2-A
 DECK GEAR LXR 01-50I-1-A
 DECK GEAR LXR 01-56-1-A
 DECK GEAR LXR 01-56-2-A
 DECK OFFICE 1-34-1-Q
 DECK OFFICE 1-34-2-Q
 DEPARTMENT HEAD SR 03-62-1-L
 DEPARTMENT HEAD SR 03-62-2-L
 DEPARTMENT HEAD SR 03-62-7-L
 DEPARTMENT HEAD SR 03-62-8-L
 DEPARTMENT HEAD SR 03-68-1-L
 DRYING RM 1-60-7-Q
 DRY PROY STRM & PROY ISS RM 01-60-0-A
 DECK GEAR LXR 01-50E-2-A
 E. EDUCTOR TRUNK 4-24-2-T
 ELEC SHOP 2-82-2-Q
 ELECTRONICS SHOP 05-74-1-C
 EMERGENCY GENERATOR RM 2-45-2-E
 ELEC FORKLIFT TRUCK STWG 1-50B-2-A
 ELEV MCHRY RM 1-50B-3-Q

ENCLOSED OPERATING STATION 2-74-0-E
 ENGINE ROOM 3-62-3-E
 ESCAPE TRUNK 3-62-1-T
 ESCAPE TRUNK 3-94-2-T
 EXECUTIVE OFFICER OFFICE 04-62-3-L
 EXECUTIVE OFFICER SR 04-62-0-L
 EMERGENCY GEN F.O. TANK 2-45-4-F
 EMERGENCY GEN L.O. TANK 2-45-6-F
 ENGR STRM 1-14-2-A
 FAN RM & ACCESS 1-59-0-Q
 FAN ROOM 01-62-4-Q
 FAN ROOM 01-34-2-Q
 FAN ROOM 1-64-0-Q
 FAN ROOM 02-62-0-Q
 FAN ROOM 05-74-3-C
 FAS CONTROL BOOTH NO. 1 02-45-1-E
 FAS CONTROL BOOTH NO. 2 02-45-2-E
 FAS CONTROL BOOTH NO. 6 02-50H-2-E
 FAS CONTROL BOOTH NO. 7 02-56-1-E
 FAS CONTROL BOOTH NO. 8 02-56-2-E
 FATHOMETER TRUNK 4-33-1-T
 FILTER CLEAN SHOP 1-112-2-Q
 FIRE ROOM 3-82-0-E
 FOOD SERVICE MGT OFFICE 01-68-2-Q
 FORCED DRAFT BLOWER RM 1-88-0-E
 FREEZE STRM 01-60-3-A
 FUEL OVERFLOW TANK 4-60-0-F
 FUEL SERVICE TANK 3-98-1-F
 FLMB LIQUID STRM 2-112-1-K
 FREEZE STRM 01-62-1-A
 FAN ROOM 01-50E-1-Q

F. FAN RM & ACCESS 1-59-0-Q
 FAN ROOM 01-62-4-Q
 FAN ROOM 01-34-2-Q
 FAN ROOM 1-64-0-Q
 FAN ROOM 02-62-0-Q
 FAN ROOM 05-74-3-C
 FAS CONTROL BOOTH NO. 1 02-45-1-E
 FAS CONTROL BOOTH NO. 2 02-45-2-E
 FAS CONTROL BOOTH NO. 6 02-50H-2-E
 FAS CONTROL BOOTH NO. 7 02-56-1-E
 FAS CONTROL BOOTH NO. 8 02-56-2-E
 FATHOMETER TRUNK 4-33-1-T
 FILTER CLEAN SHOP 1-112-2-Q
 FIRE ROOM 3-82-0-E
 FOOD SERVICE MGT OFFICE 01-68-2-Q
 FORCED DRAFT BLOWER RM 1-88-0-E
 FREEZE STRM 01-60-3-A
 FUEL OVERFLOW TANK 4-60-0-F
 FUEL SERVICE TANK 3-98-1-F
 FLMB LIQUID STRM 2-112-1-K
 FREEZE STRM 01-62-1-A
 FAN ROOM 01-50E-1-Q

(FOR CONTINUATION SEE PLT 2 - FR 2 OF 2)

(CONT'D FROM PLT 2 FR 1 OF 2)

FUEL SERVICE TANK	3-98-4-F	MEDICAL STRM	1-27-2-A	PASSAGE	1-60-2-L	PASSAGE	04-74-0-L	SMALL ARMS MAGAZINE	2-112-8-M
FUEL TANK	4-58-1-F	MEDICAL STRM	01-84-2-A	PASSAGE	1-60-4-L	PASSAGE	04-74-2-L	SMALL ARMS MAGAZINE	1-60-3-A
FUEL TANK	4-58-2-F	MEDICAL TREATMENT RM & MAIN		PASSAGE	1-61-2-L	PASSAGE	05-68-0-L	STEERING GEAR ROOM	2-122-0-E
FUEL TANK	4-60-1-F	BATTLE DRESSING STATION	01-77-2-L	PASSAGE	1-62-1-L	PASSAGE	05-73-1-L	SUMP TANK	4-24-0-Y
FUEL TANK	4-60-2-F	METALSMITH SHOP	1-45-5-Q	PASSAGE	1-62-2-L	PASSAGE	05-73-2-L	SUPPLY SUPPORT CENTER	2-67-2-Q
FWD BATTLE DRESSING STATION	1-28-2-L	MOORING STATION	1-49-3-Q	PASSAGE	1-76-2-L	PASSAGE	06-68-0-L	SUPPLY/DISBURSING OFFICE	1-76-1-Q
FWD FLMB LIO ISSUE RM	1-27-1-X	MOORING STATION	1-49-4-Q	PASSAGE	1-82-1-L	PASSAGE	08-74-1-L	T. TEST LAB (OIL, WATER & GASES)	2-94-4-Q
FWD PEAK TANK	4-H-0-W	N. NIXIE ELEX EQPT SPACE	2-135-0-Q	PASSAGE	1-82-2-L	PASSAGE	06-74-2-L	TRASH COMPACTOR RM	01-86-2-Q
FWD REPAIR NO. 2	1-27-6-Q	O. OFFICE COMPLEX	1-67-1-Q	PASSAGE	1-88-2-L				
FW.S.W. DECON STA #2	02-82-4-L	OFFICE BAGGAGE	04-72-2-A	PASSAGE	1-89-1-L				
6. GALLEY	01-72-0-Q	OFFICE LOUNGE	03-74-0-L	PASSAGE	1-94-0-L			U. UNDERWATER LOG TRUNK	4-49-1-T
GENERAL WORKSHOP	2-82-1-Q	OFFICE SR	03-68-2-L	PASSAGE	1-94-1-L			UPTAKE SPACE	1-82-0-Q
STM	1-112-1-Q	OFFICE SR	03-74-3-L	PASSAGE	1-112-0-L			UNREP EQPT SHOP	1-46-1-Q
GALLEY STORES LKR/DRY PROV STRM #2	01-74-3-A	OFFICE SR	03-74-4-L	PASSAGE	1-114-1-L			V. VOID	4-102-0-Y
		OFFICE SR	03-78-1-L	PASSAGE	02-62-1-L			VOID	4-127-0-Y
		OFFICE SR	03-78-2-L	PASSAGE	02-62-2-L			VALVE MAINT SHCP	1-60-3-A
		OFFICE SR	03-78-2-L	PASSAGE	02-62-3-L			Y. YARD	01-71-2-L
H. HALON CYLINDER STRM	1-29-2-A	OILY WASTE HOLDING TANK	4-63-0-F	PASSAGE	02-67-0-L	PILOTHOUSE	06-62-0-C	WARD BATH	01-68-4-L
HALON CYLINDER OPERATING STATION	2-80-2-Q	OFFICER SR	04-62-2-L	PASSAGE	02-67-2-L	POST OFFICE	1-76-3-Q	WARDROOM MESSROOM	01-64-1-L
HELICOPTER CRASH RSQ LKR	01-92-2-A	OFFICER SR	04-68-2-L	PASSAGE	02-69-1-L	POTABLE WATER TANK	3-62-2-Y	WASTE OIL TANK	4-61-0-F
HELICOPTER CONTROL STATION	02-100-0-C	OHE STWG	1-50F-1-A	PASSAGE	02-81-2-L	POTABLE WATER TANK	3-66-2-Y	WINCH MOTOR CONTROLLER RM	1-45-0-E
I. I.C. ROOM	2-62-0-C	P. PALLET TRUCK STNG AND CHARGING STA	01-33-2-Q	PASSAGE	2-24-0-L	PROPULSION REPAIR NO 5	1-91-2-Q	WINDLASS RM	1-23-0-E
INCINERATOR RM	01-94-0-Q	PASSAGE	01-27-0-L	PASSAGE	2-47-1-L	PUMP RM NO 1 (JP-5)	4-45-0-E	WIRE REEL STRM	1-49-0-A
INACCESSIBLE VOID	4-112-0-Y	PASSAGE	01-60-01-L	PASSAGE	2-48-2-L	PUMP RM NO 2 (OIL)	4-58-0-E	WR & CPO MESSROOM ANNEX	01-68-1-L
J. JP-5 STORAGE TANK	4-45-2-J	PASSAGE	01-61-1-L	PASSAGE	2-62-2-L	POLLUTION CONTROL LKR	01-34-1-A	WR & CPO SERVING ANNEX	01-72-1-Q
		PASSAGE	01-62-2-L	PASSAGE	2-66-1-L	POLLUTION CONTROL LKR	01-34-2-A		
L. LADIES RM	01-64-2-L	PASSAGE	01-80-0-L	PASSAGE	2-77-2-L	R. RADAR ROOM	06-77-0-C		
LAUNDRY	1-60-0-Q	PASSAGE	01-94-1-L	PASSAGE	2-79-1-L	RADIO TRANSMITTER RM	04-72-1-C		
LOCKER	06-76-1-A	PASSAGE	01-94-1-L	PASSAGE	2-88-2-L	RAS CONTROL BOOTH STA NO 3	02-50C-1-E		
LOCKER	06-76-2-A	PASSAGE	01-98-1-L	PASSAGE	2-97-0-L	RAS CONTROL BOOTH STA NO 4	02-50C-2-E		
LUBO SETLG TX	3-78-8-F	PASSAGE	1-27-3-L	PASSAGE	2-115-0-L	RFW TANK	4-72-0-Y		
LUBO STOR TX	3-78-6-F	PASSAGE	1-27-4-L	PASSAGE	2-119-1-L	RFW TANK	4-82-0-W		
LUBO SUMP TX	4-76-0-F	PASSAGE	1-45-1-L	PASSAGE	03-68-0-L	RFW TANK	4-83-0-W		
LUBO SETLG TX	3-80-4-F	PASSAGE	1-45-2-L	PASSAGE	03-63-0-L	REGISTERED PUBLICATION OFFICE	05-68-2-Q		
LUBO STOR TX	3-80-2-F	PASSAGE	1-49-1-L	PASSAGE	03-73-1-L	S. SANITARY SPACE	3-98-0-L		
LUBO STOR TX	3-81-2-F	PASSAGE	1-49-2-L	PASSAGE	03-73-2-L	SANITARY SPACE	3-78-2-L		
		PASSAGE	1-59-1-L	PASSAGE	04-68-0-L	SCULLERY	01-74-1-Q		
M. MCHRT REMOVAL TRX	2-62-4-T	PASSAGE	1-60-1-L	PASSAGE	04-70-1-L	SD STOREROOM (REPAIR PARTS)	2-62-01-A		
MEDICAL OFFICE	01-82-2-L	PASSAGE	01-62-1-L	PASSAGE	01-61-2-L	SD STOREROOM (BULK)	2-62-6-A		
3M S. CAREER COUNSELORS OFFICE	2-94-2-Z	PASSAGE	01-79-1-L	PASSAGE	02-92-2-L	SHIP STORE	1-78-2-Q		
		PASSAGE		PASSAGE		SHIP STORE STRM	1-68-0-A		
				PASSAGE		SIGNAL SHELTER	07-64-0-Q		
				PASSAGE		SELF DEFENSE FORCE LOCKER	2-117-1-A		
				PASSAGE		STREAM EQPT LKR	01-50F-1-A		

TOTAL ACCOMMODATIONS				
PERSONNEL	BEDS	BERTH TRANSOMS	BERTHS	LOCKERS
COMMANDING OFFICER	1			
EXECUTIVE OFFICER	1			
OFFICERS STATEROOM		14		
HOSPITAL			4	
CGPO LIVING SPACE			14	
CREW NO. 1			40	40
CREW NO. 2			23	23
CREW NO. 3			17	17
CREW NO. 4			39	39
CREW NO. 5			39	39
CREW NO. 6			58	58
TOTAL	2	14	234	216

CAPACITY OF ROOMS		
ROOM	LOCATION	WORKING LOAD
CARGO	01 LEVEL ON KING POST AT FR 50E P/S	10 LONG TON
BOAT	01 LEVEL AT FR 63 STB	STATIC TEST 150 PER LIN.FT TOTAL 6500
SSA1	01 LEVEL AT FR 55 PORT	

HEIGHTS		
ROTATING ANTENNAS	LOCATION	HEIGHT
ANT LN-56/4 (RADAR)	CL FR 65	122'-1 1/2" ABL
OE-172/SPS-55	CL FR 71	151'-2 1/2" ABL
AS-3018/WSC-1Y	STB J FR 95	116'-4 7/16" ABL
AS-3018/WSC-1Y	CL FR 68	122'-7" ABL

GENERAL DIMENSIONS	
LENGTH, BETWEEN PERPENDICULARS.....	658'-0"
LENGTH, OVERALL.....	639'-6"
BREADTH, EXTREME.....	88'-2 1/4"
DRAFT, ABOVE BOTTOM OF KEEL CORRESPONDING TO FWD	52'
FULL LOAD DISPLACEMENT.....	3155' 31.82'
DRAFT, ABOVE LOWEST PROJECTION BELOW KEEL	FWD AFT
CORRESPONDING TO FULL LOAD DISPLACEMENT.....	35.45' 35.72'

LIST OF MAJOR MACHINERY		
ITEM NO	DESCRIPTION	MANUFACTURER
1	1 MAIN BOILER - STD - 1A	COMBUSTION ENG
2	1 MAIN BOILER - PORT - 1B	
3	1 LP TURBINE - NO. 1	GENERAL ELECTRIC
4	1 HP TURBINE - NO. 1	
5	1 MAIN CONDENSER - NO. 1	A.S.I.
6	1 MAIN REDUCTION GEAR - NO. 1	GENERAL ELECTRIC
19	1 MAIN FEED PUMP - 1A	WORTHINGTON
20	1 MAIN FEED PUMP - 1B	
31	1 FORCED DRAFT BLOWER - 1A	GREEN FAN CO.
32	1	1A2
35	1	1B1
34	1	1B2
44	1 S/S TURBO GEN SET - 1A	GENERAL ELECTRIC
45	1	1B
46	1	1C
69	1 LP AIR COMPRESSOR - NO. 1	WORTHINGTON CEI INC
70	1	2
71	1	3
72	1	4
135	1 LINE SHAFT - 1A	A.S.I.
140	1	1B
141	1 BEARING - 1A	
142	1	1B
401	1 UNIT SHELL MOTOR 25 TON WATER CHL SYS	YORK
402	1 UNIT COMPRESSOR 25 TON	
464	1 UNIT DIESEL GENERATOR	COLT INDUSTRIES
501	1 DIESEL GENERATOR	COLT INDUSTRIES
502	1 J.P. S. CARGO PUMP NO. 1 THRU NO. 3	WARREN PUMP
503	1 CARGO PUMP NO. 4 THRU NO. 5	

(CONTINUED)

HEIGHTS		
ELEVATED PLATFORMS	LOCATION	HEIGHT
ANTENNA	5'-0" FWD OF FR 37 20'-5 3/8" OFF 6 STB	107'-7 1/2" ABL
MAIN MAST	CL FR 74	145'-9 1/2" ABL
BRIDGE	BETWEEN FR 62 & 64 P/S	105'-0" ABL

SMALL BOATS			
NO	SIZE & TYPE	EACH	TOTAL
I	40'-0" UTILITY BOAT	75	75
II	INFLATABLE LIFE BOAT MK 6 (2 TYPE 1) (8 TYPE 3)	125 PER BOAT	275
I	24'-0" RIGID INFLATABLE BOAT	15	15

HEIGHTS		
LIGHT	LOCATION	HEIGHT
FWD ANCHOR	CL JACKSTAFF	84'-7 1/4" ABL
MASTHEAD (FWD)	CL 16" FWD FR 29	97'-9 3/4" ABL
AIRCRAFT WARRING (FWD)	CL FR 29	99'-3" ABL
YARDARM BLINKER P/S	FR 74	148'-3/4" ABL
AIRCRAFT WARRING (AFT)	CL FR 74	169'-1" ABL
SHIP TACK	MAIN MAST PLTF	167'-10 3/4" ABL
		151'-0" ABL
		154'-0" ABL
AFT MASTHEAD	CL FR 74	141'-4 1/2" ABL
SIDE P/S	FR 29 P/S	64'-7 3/4" ABL
AFT ANCPGR	CL ENSIGN STAFF	68'-2 3/4" ABL
WAKE	TRANSOM (PORT)	52'-9" ABL
STERN	TRANSOM CL	52'-9" ABL
STERN	TRANSOM CL	52'-9" ABL

HEIGHTS		
MAST	LOCATION	HEIGHT
FWD MAST	CL FR 29	99'-3" ABL
AFT MAST	CL FR 74	168'-9 1/2" ABL

GENERAL DIMENSIONS
 NAVSEA 801-SIB3615
 PLATE 3 - FR101

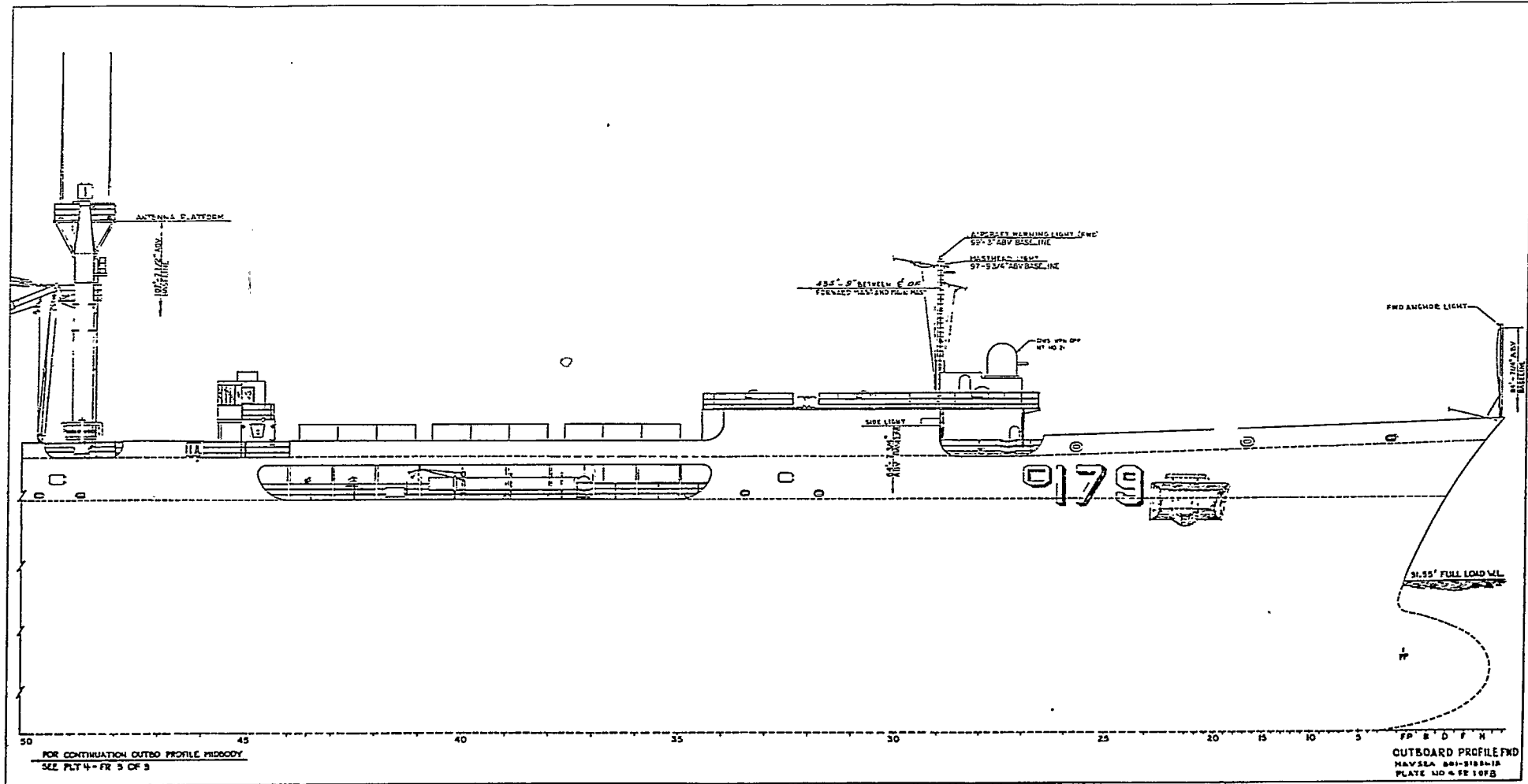

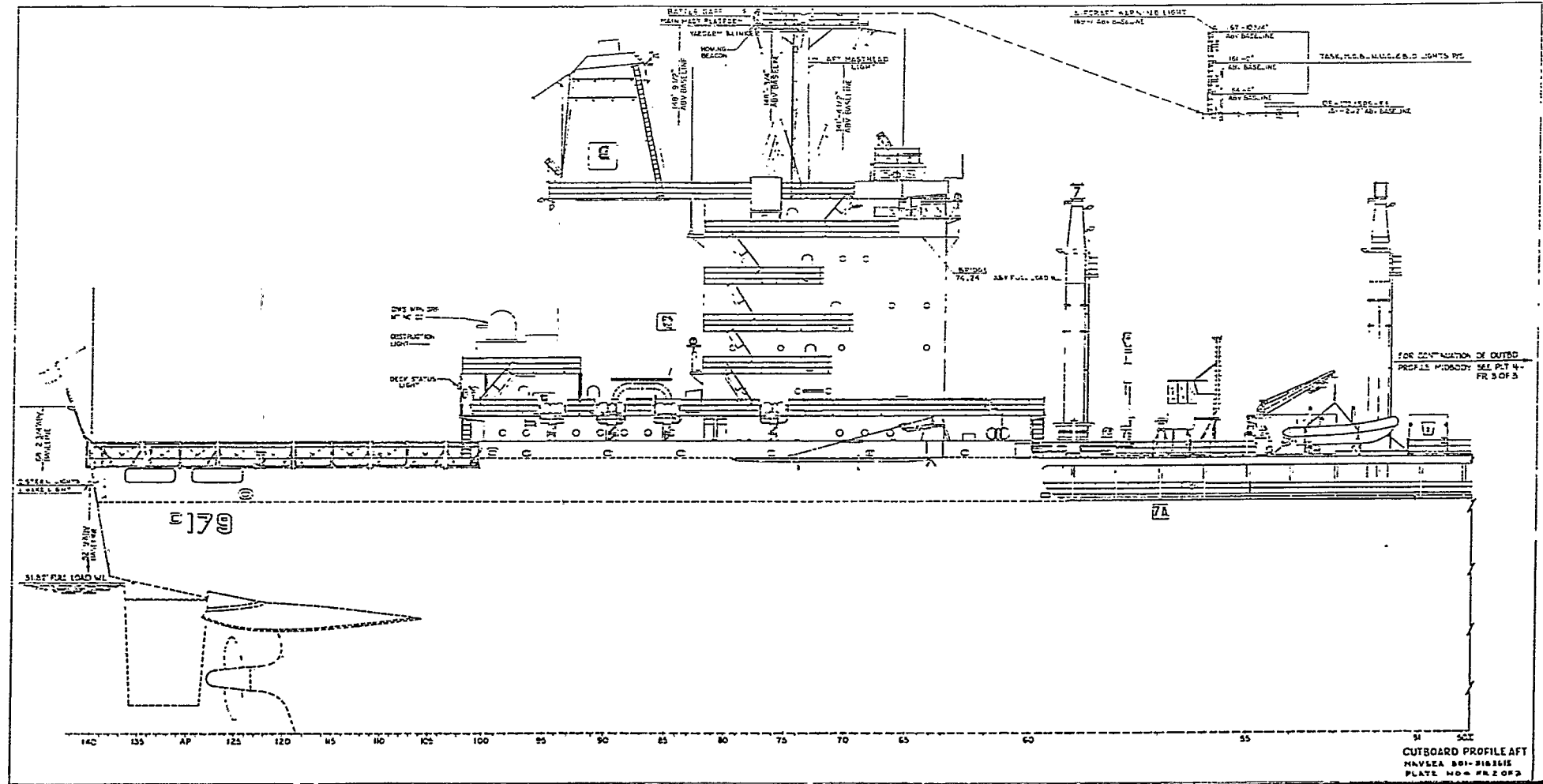

CUTBOARD PROFILE AFT
 NAVSEA 881-8181S
 PLATE NO. 4 PR. 2 OF 3

FOR CONTINUATION OF OUTBOARD PROFILE AFT
SEE PLT 4 - FR 2 OF 3

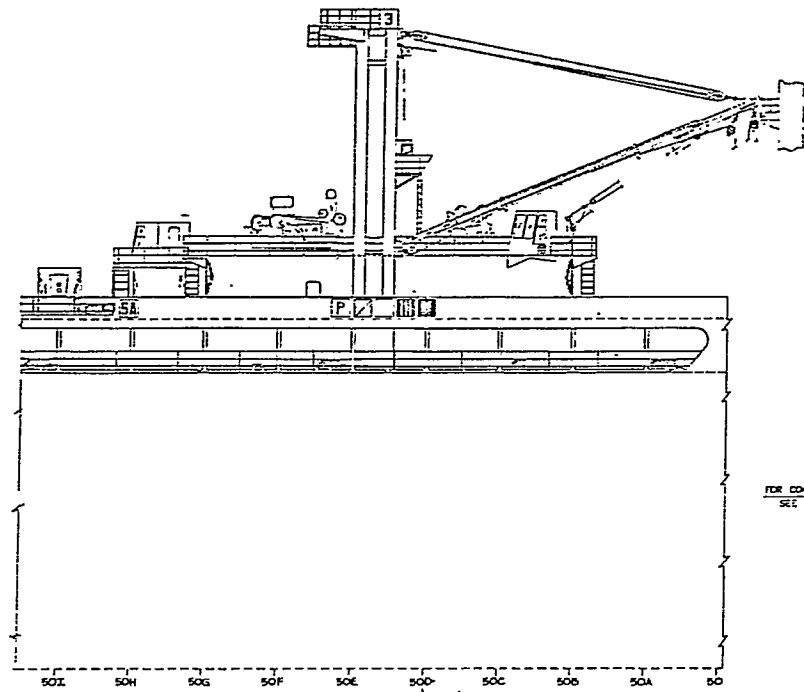

FOR CONTINUATION OUTBOARD PROFILE FWD
SEE PLT 4 - FR 1 OF 3

OUTBOARD PROFILE MIDBODY
NAVSEA 801-5143615
PLATE NO. 4 - FR 3 OF 3

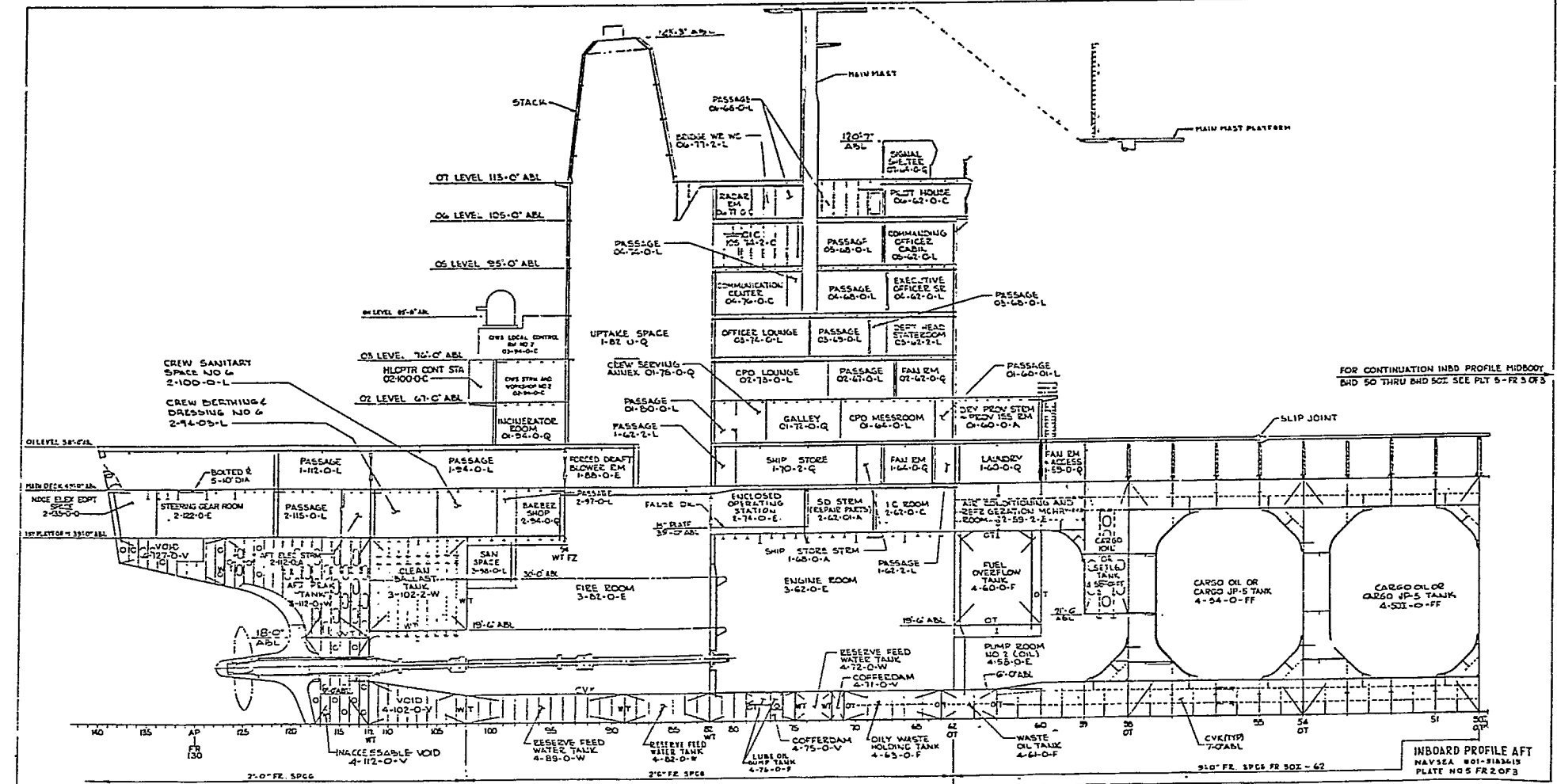

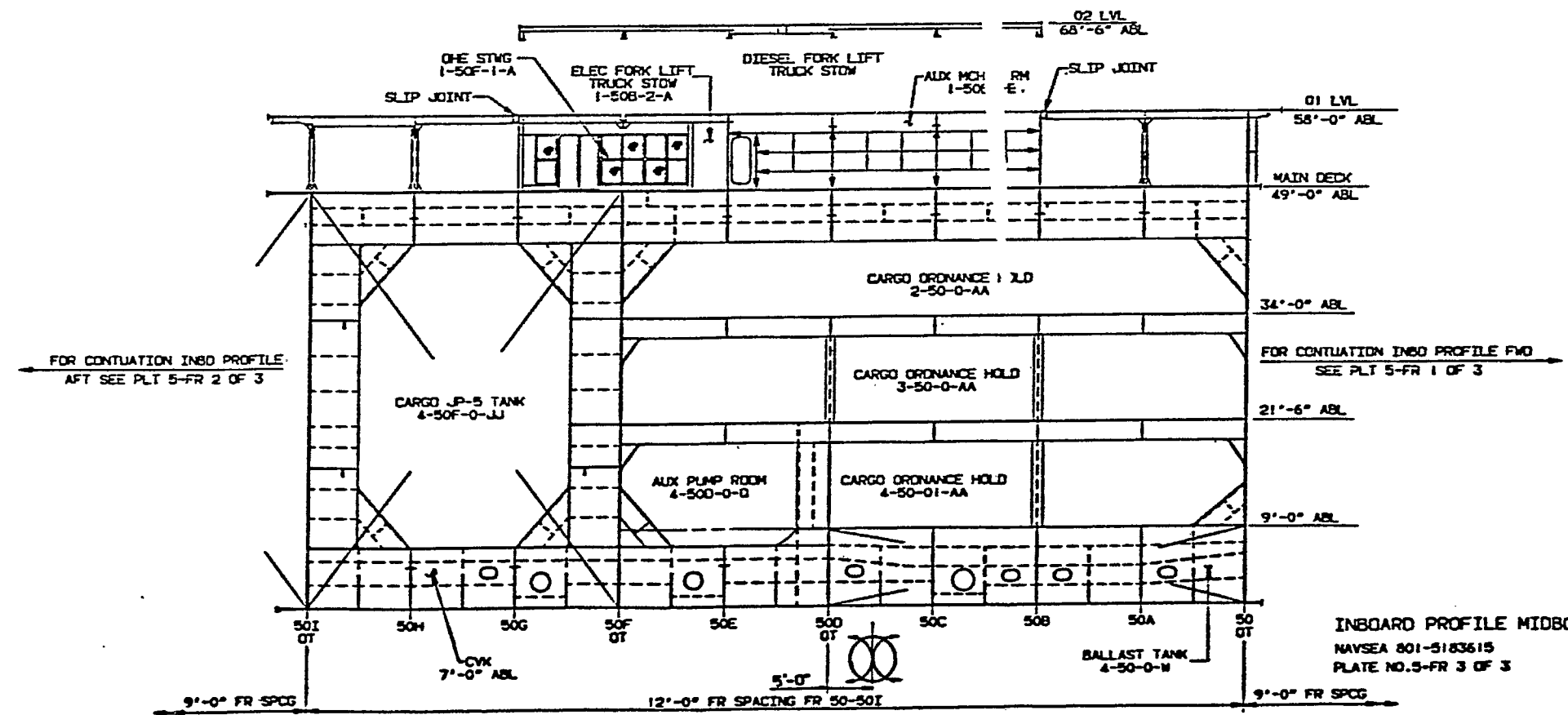

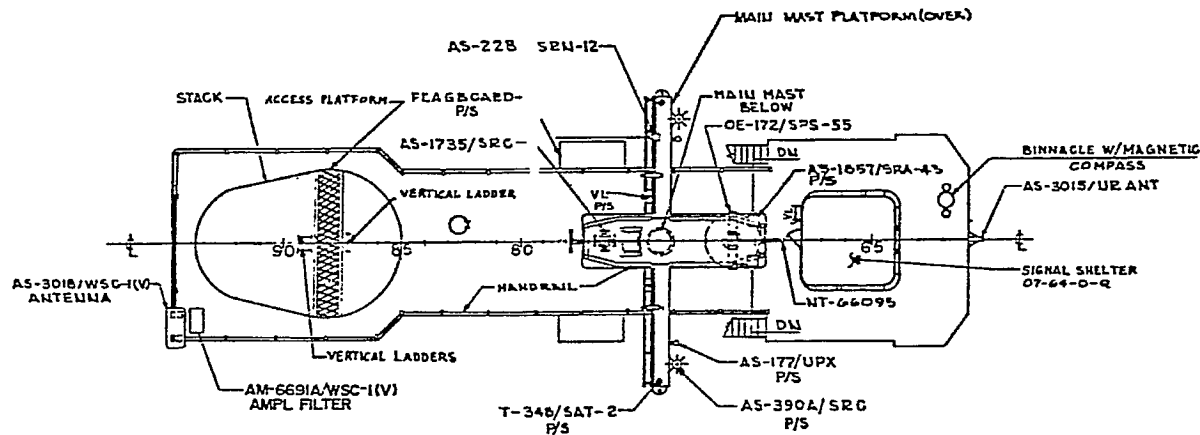
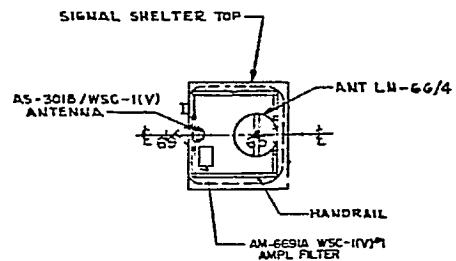
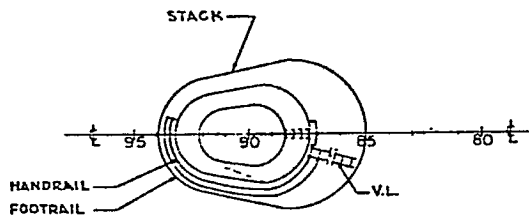

O7 LEVEL

O7 LEVEL
 NAV SEA 801-5183615
 PLATE NO. 6 FE. 10F1

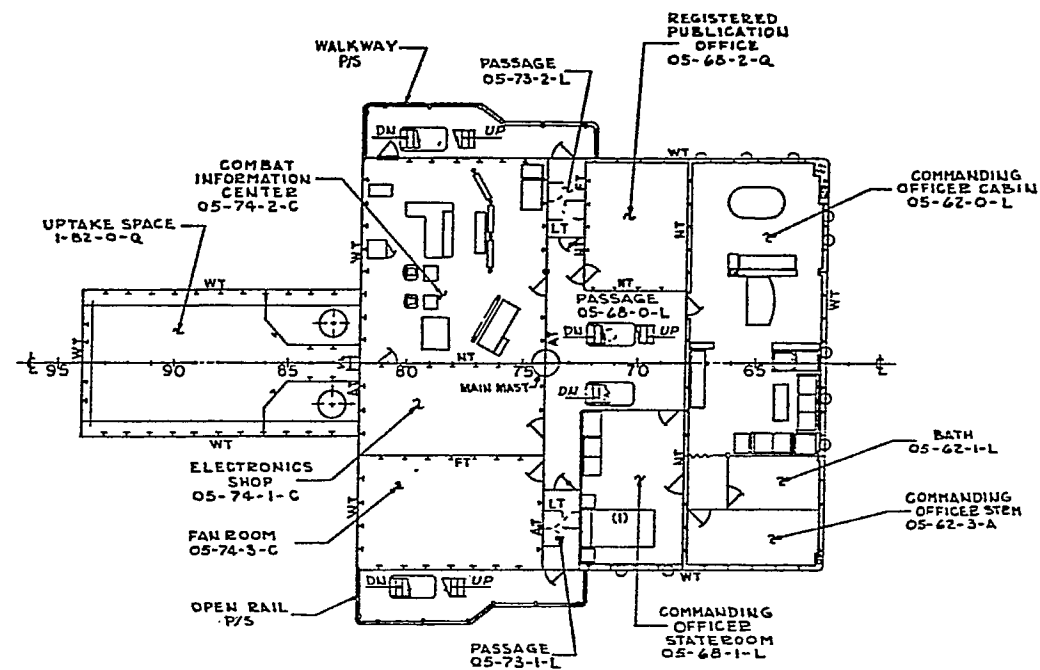

05 LEVEL

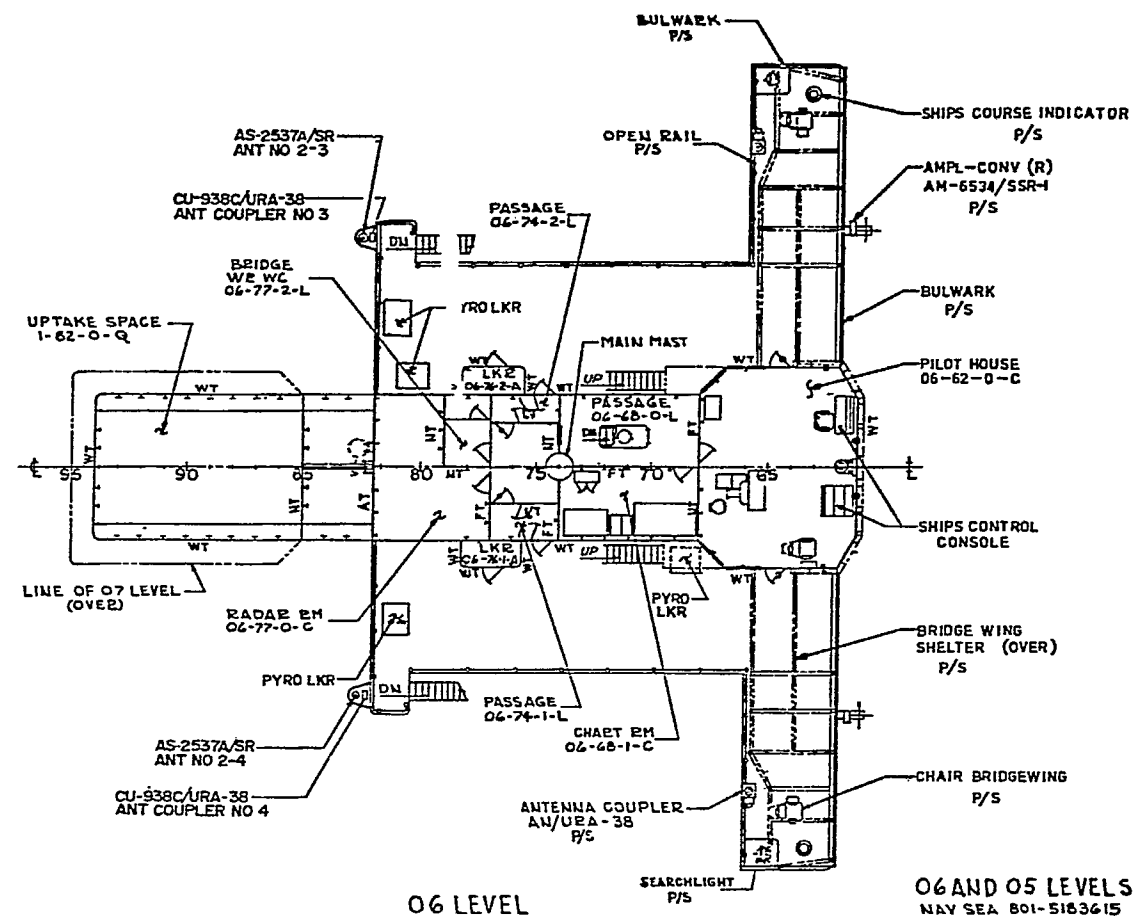

06 LEVEL

06 AND 05 LEVELS
 NAV SEA 801-5183615
 PLATE NO. 7 FE 1 OF 1

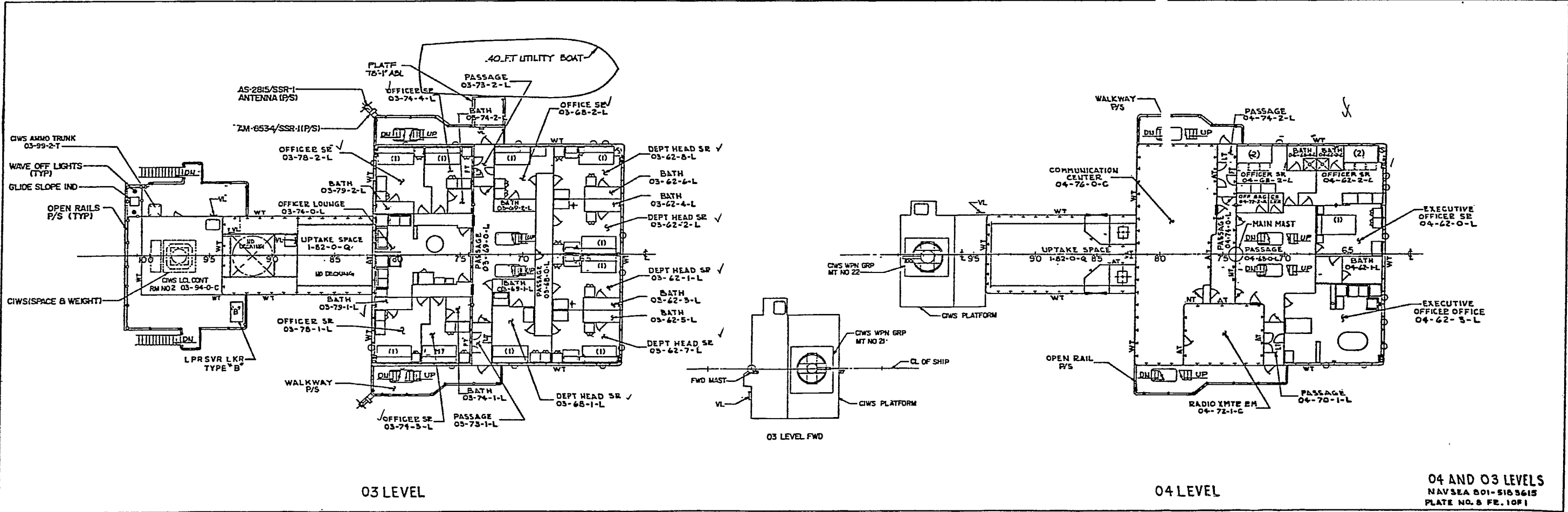

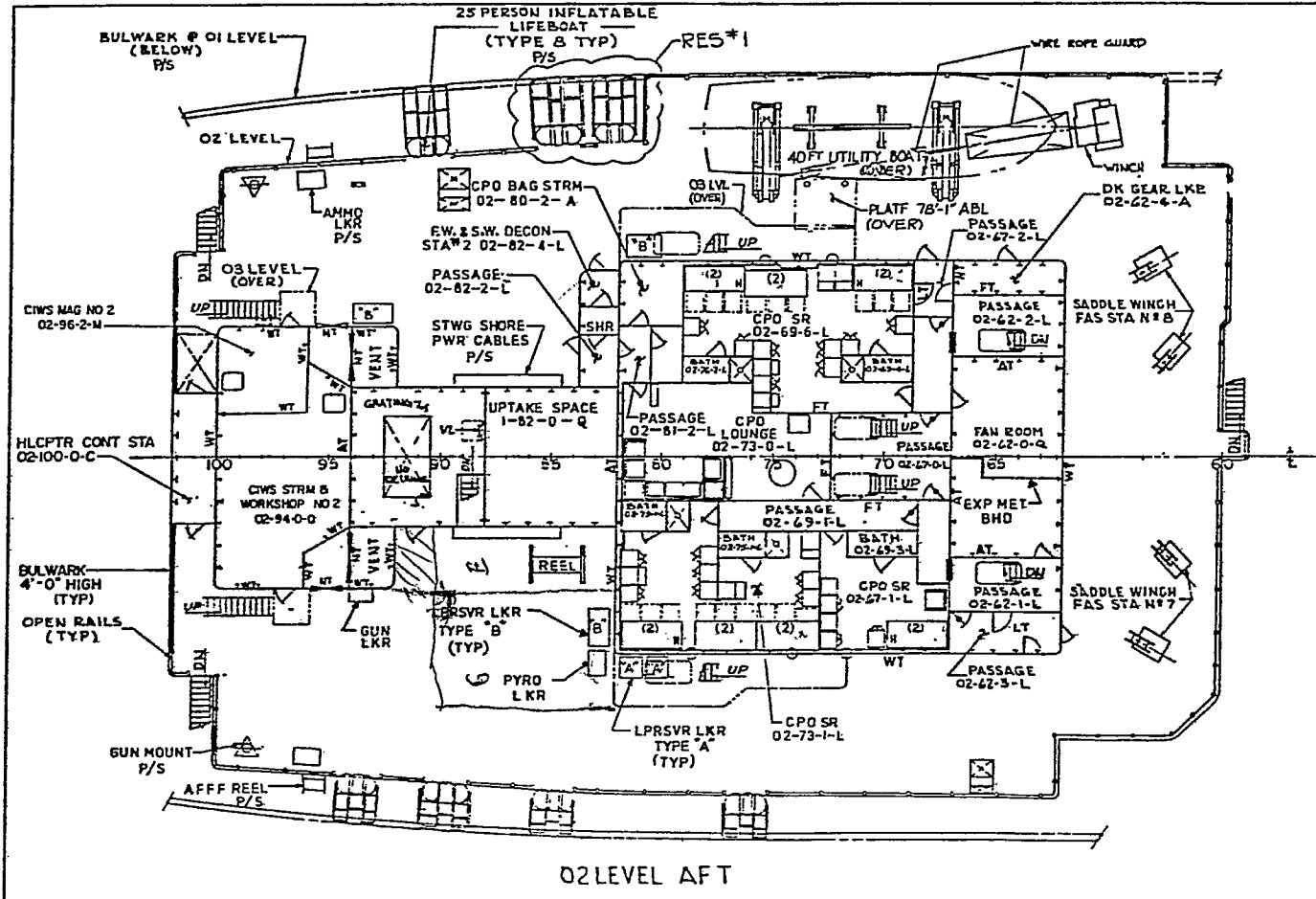

O2 LEVEL AFT

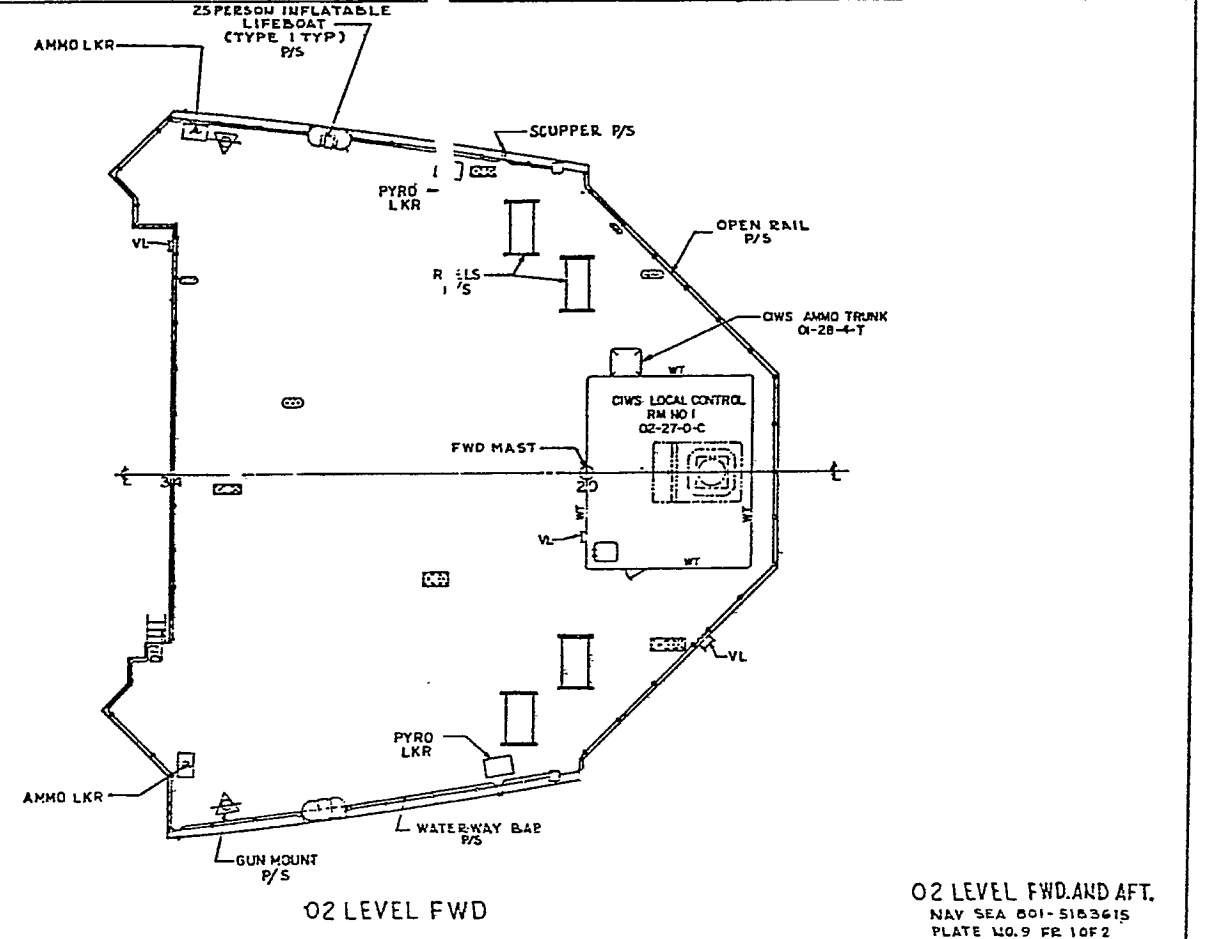

O2 LEVEL FWD

NOTE:
FOR O2 LVL MIDBODY
BHD SEE THRU BHD 5061
SEE PLT 9-FR 2 OF 2

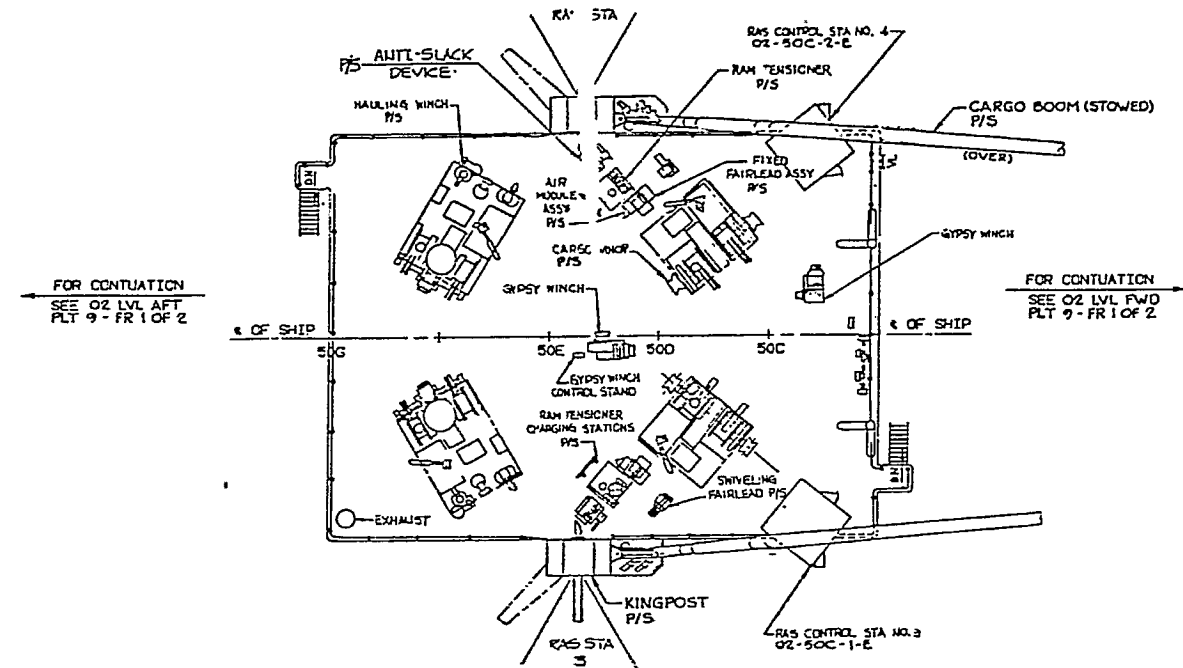

02 LEVEL MIDBODY
 NAVSEA 801-5183615
 PLATE NO. 9 - FR 2 OF 2

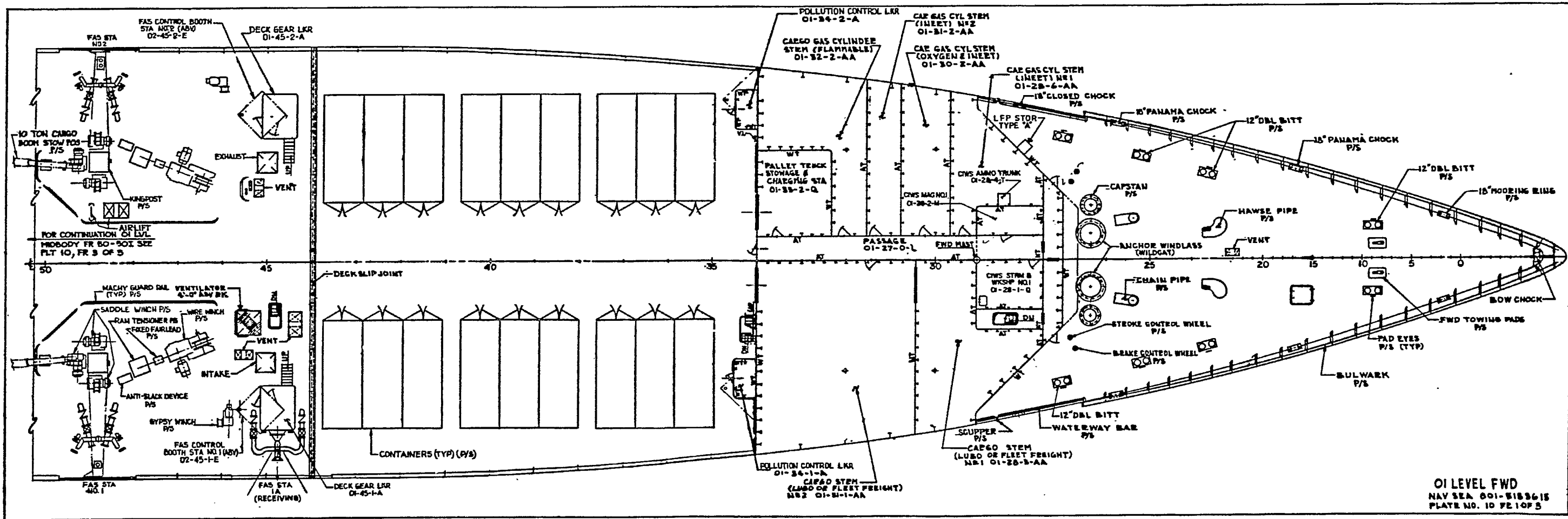

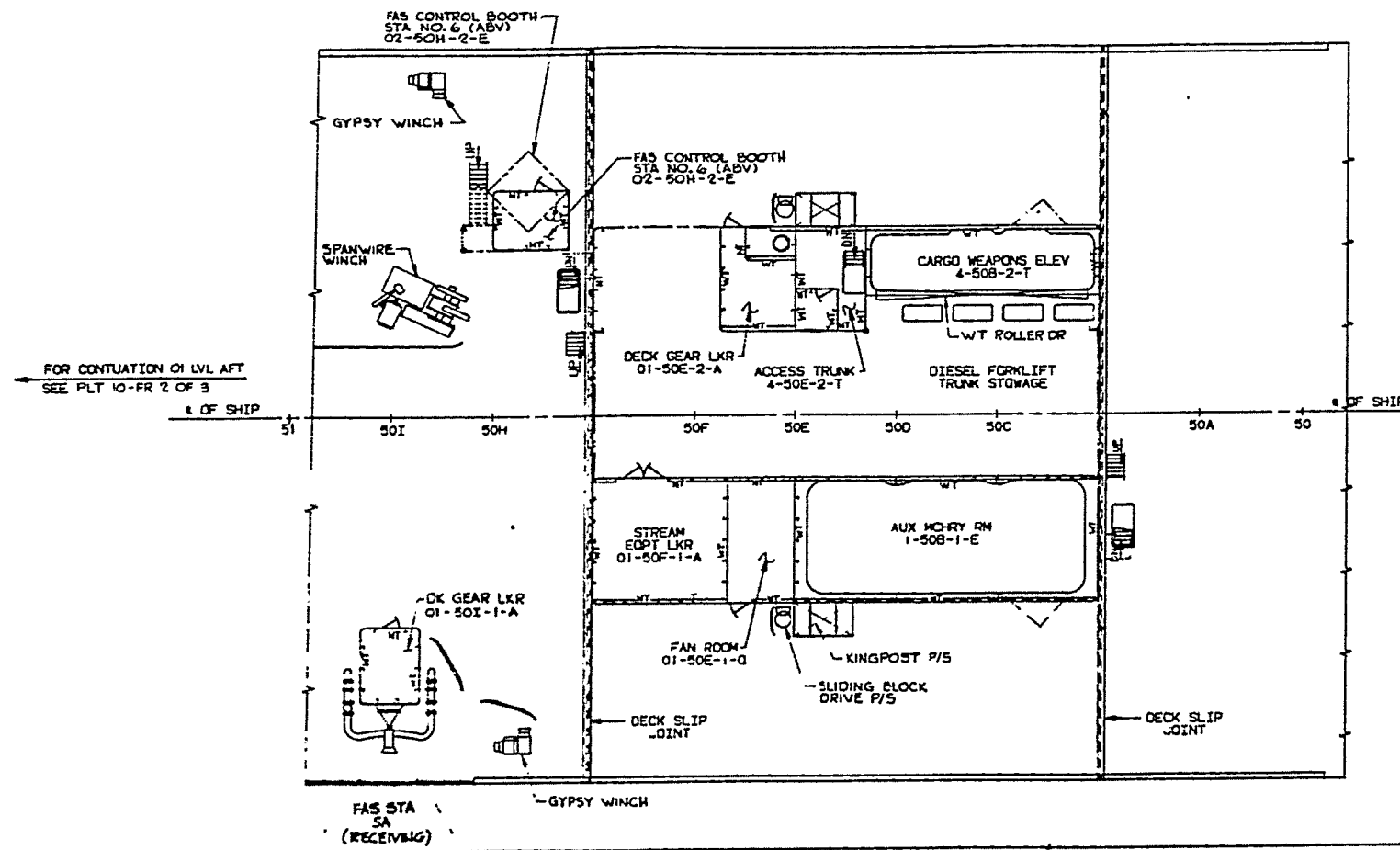

01 LEVEL MIDBODY
NAVSEA 801-5183615
PLATE NO. 10-FR 3 OF 3

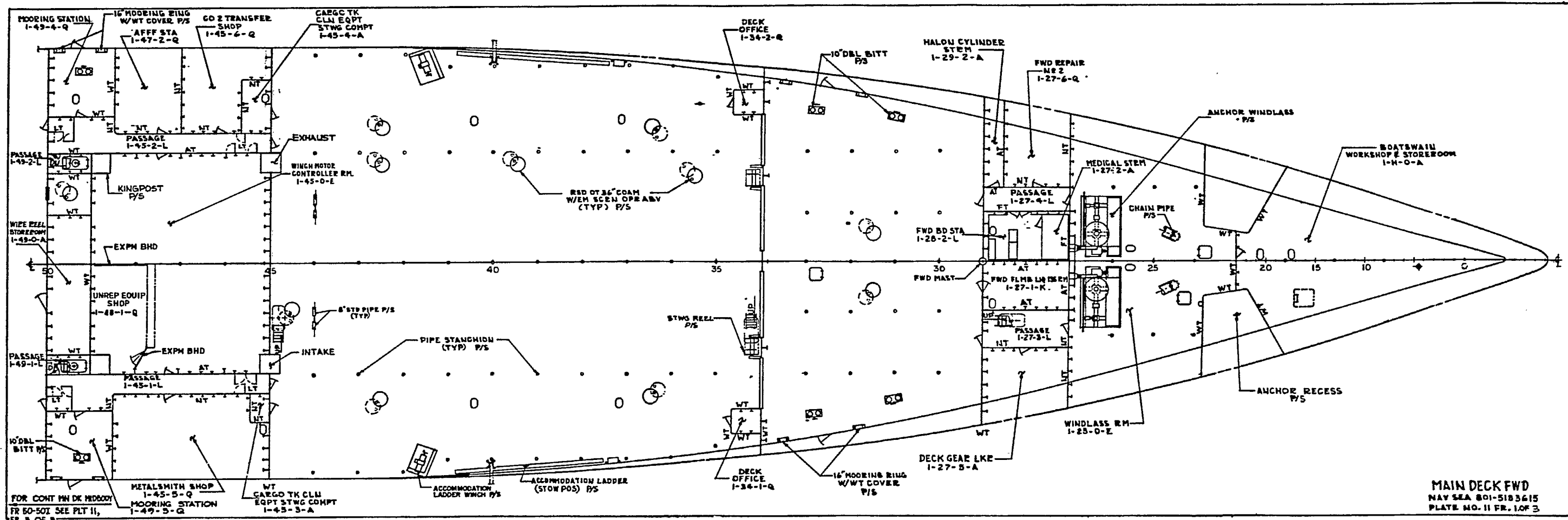

MAIN DECK FWD
 NAV SEA 801-5183&15
 PLATE NO. 11 FR. 1 OF 3

FOR CONT MN DK MIDBODY
 FR 50-501 SEE PLT II,
 FR 3 OF 5

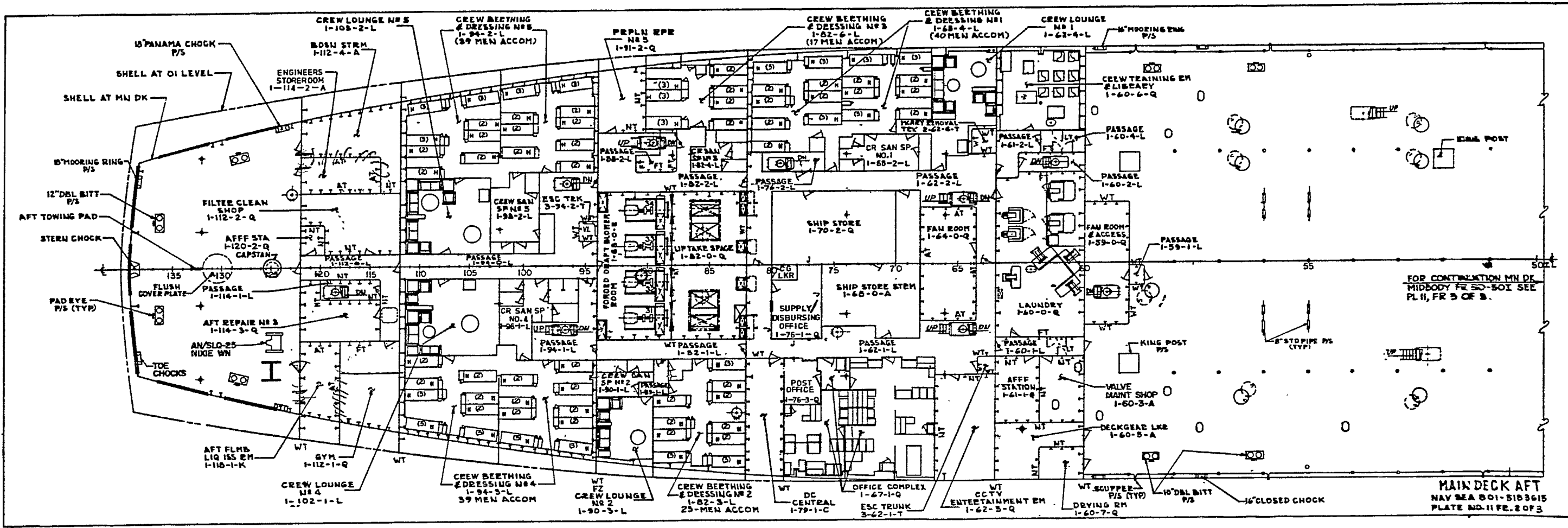

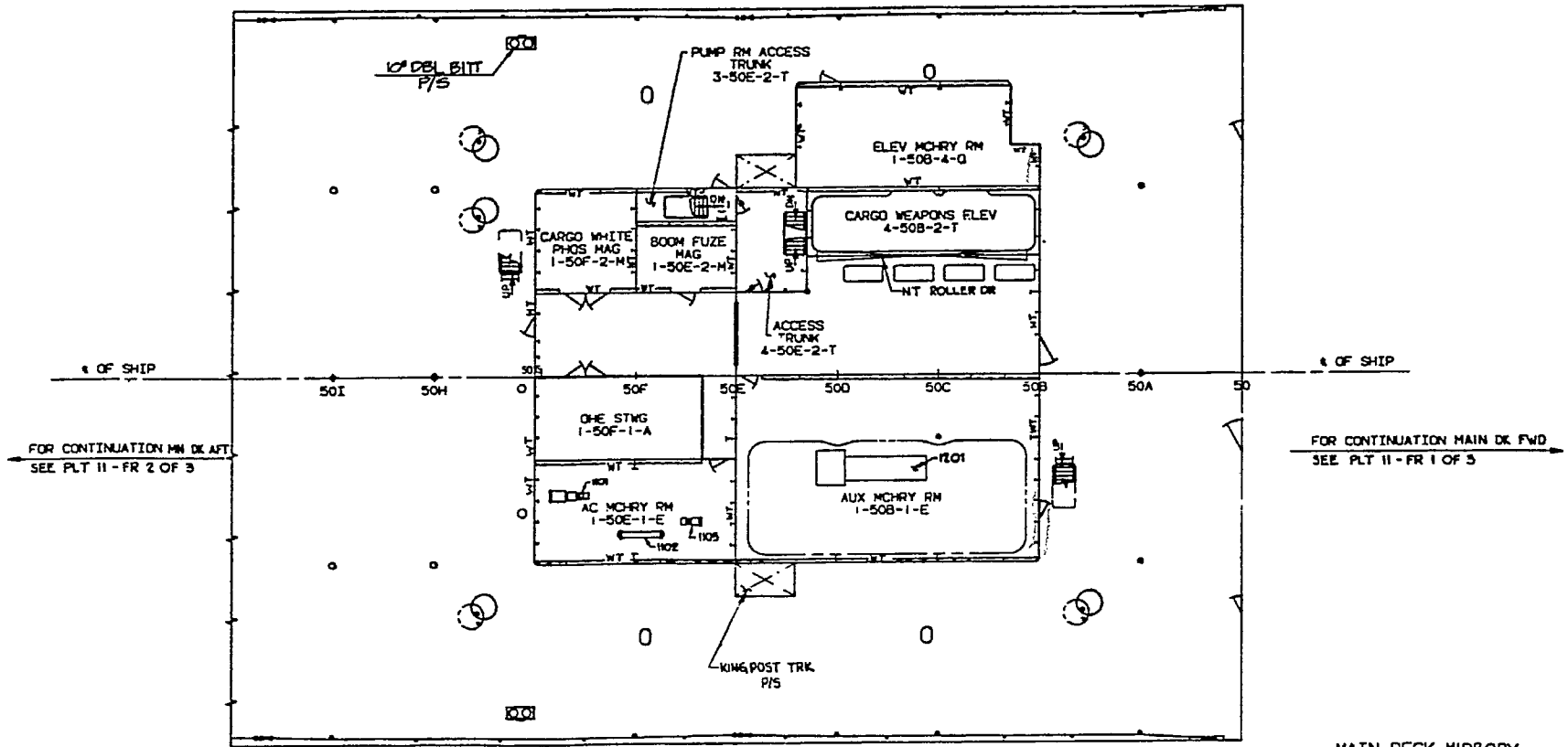

MAIN DECK MIDBODY
 NAVSEA 801-5183615
 PLATE NO. 11 FR 3 OF 3

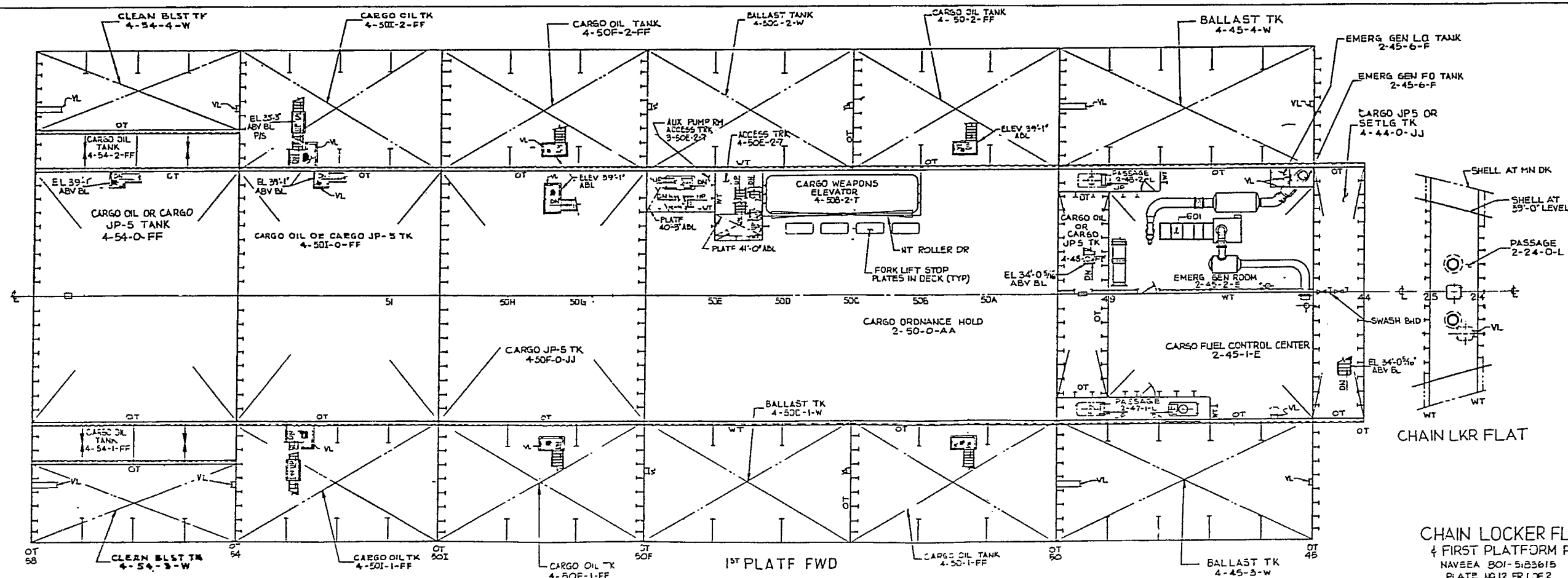

CHAIN LKR FLAT

CHAIN LOCKER FLAT
 1st PLATFORM FWD
 NAVSEA 801-583615
 PLATE NO 12 FRI 3F2

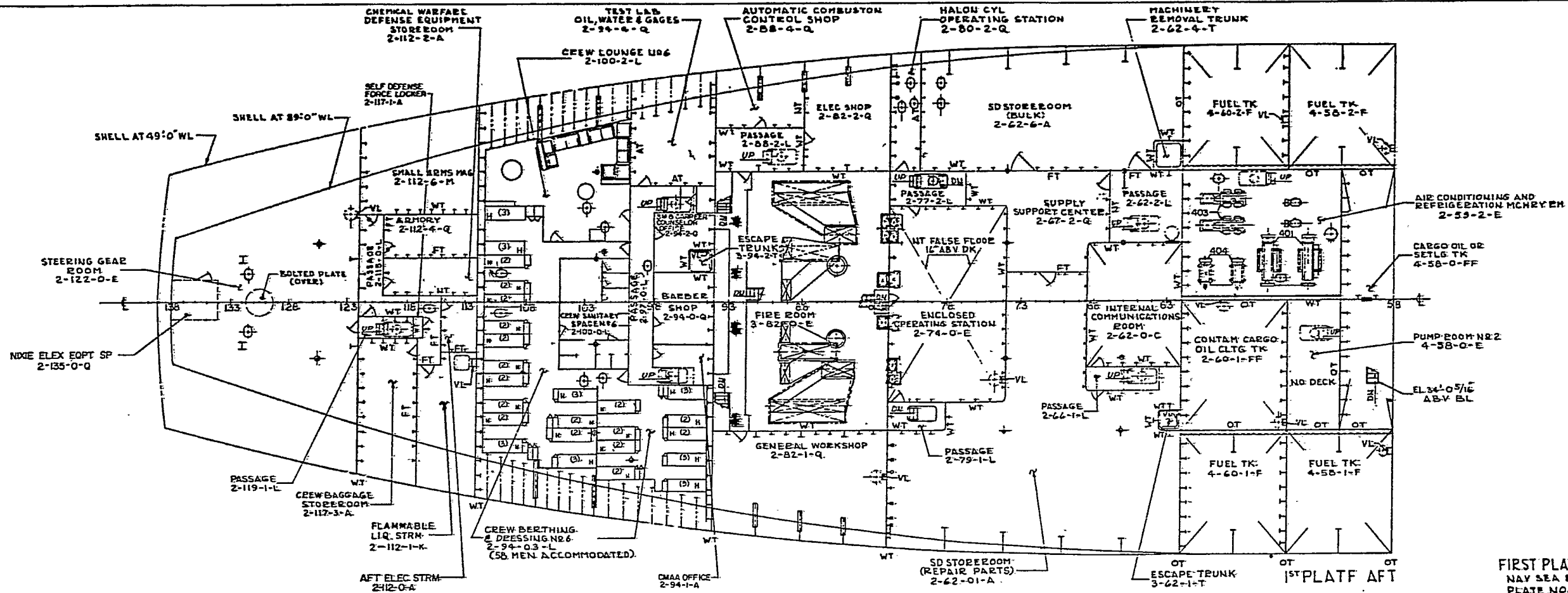

FIRST PLATFORM AFT.
 NAV SEA 801-5183615
 PLATE NO. 12 FR. 2 OF 2

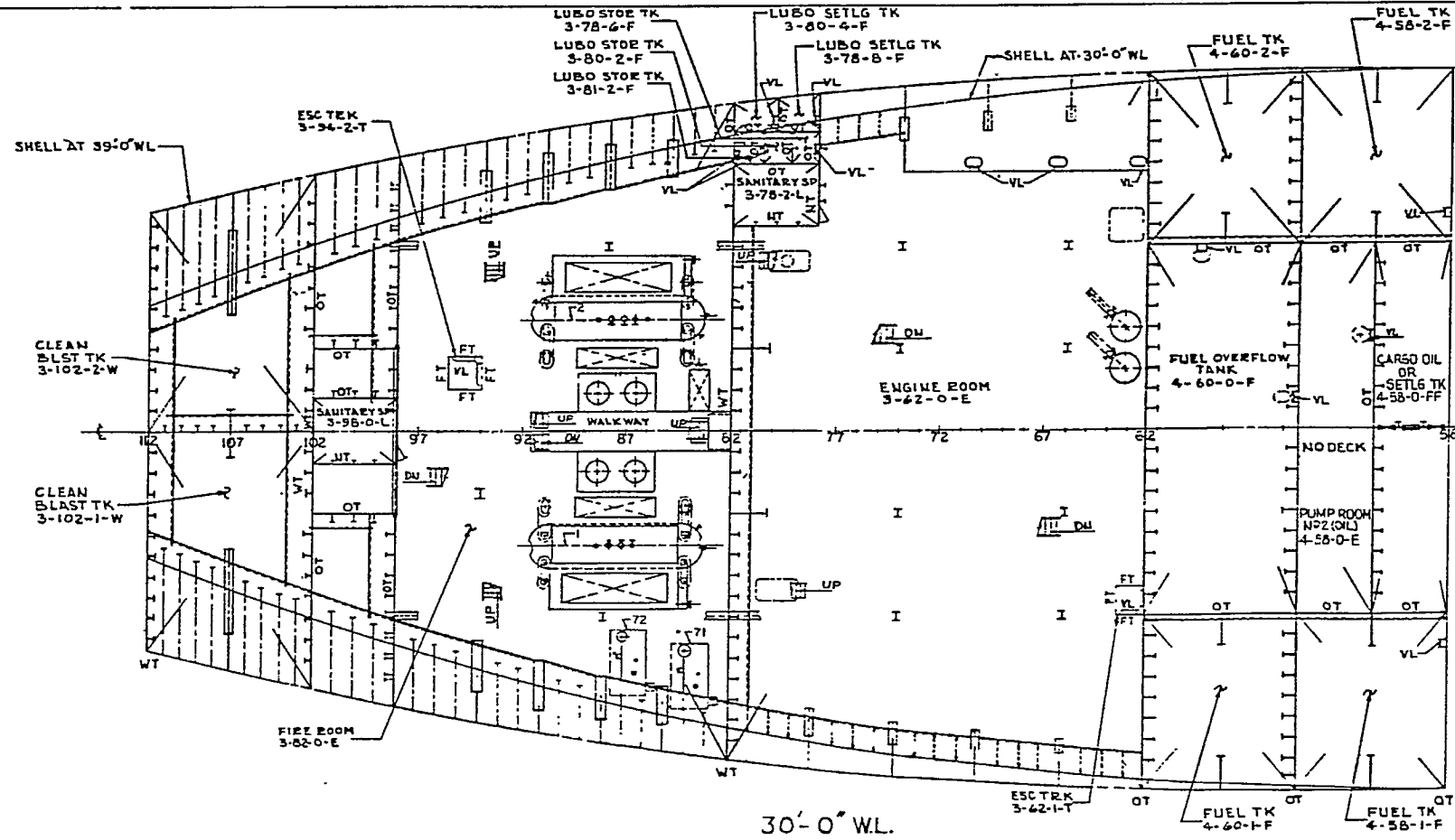

30'-0" WL.

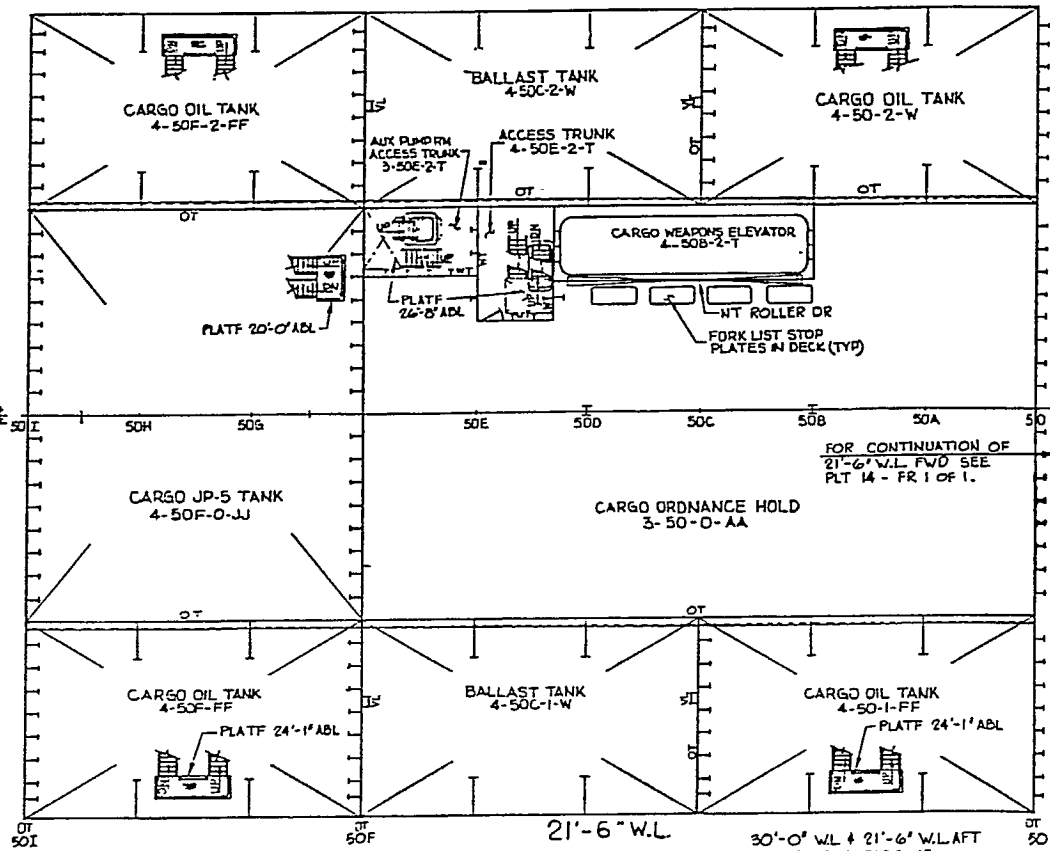

21'-6" WL.

30'-0" WL & 21'-6" WL AFT
 NAVSEA 801-5183615
 PLATE NO. 15-FR 1 OF 1

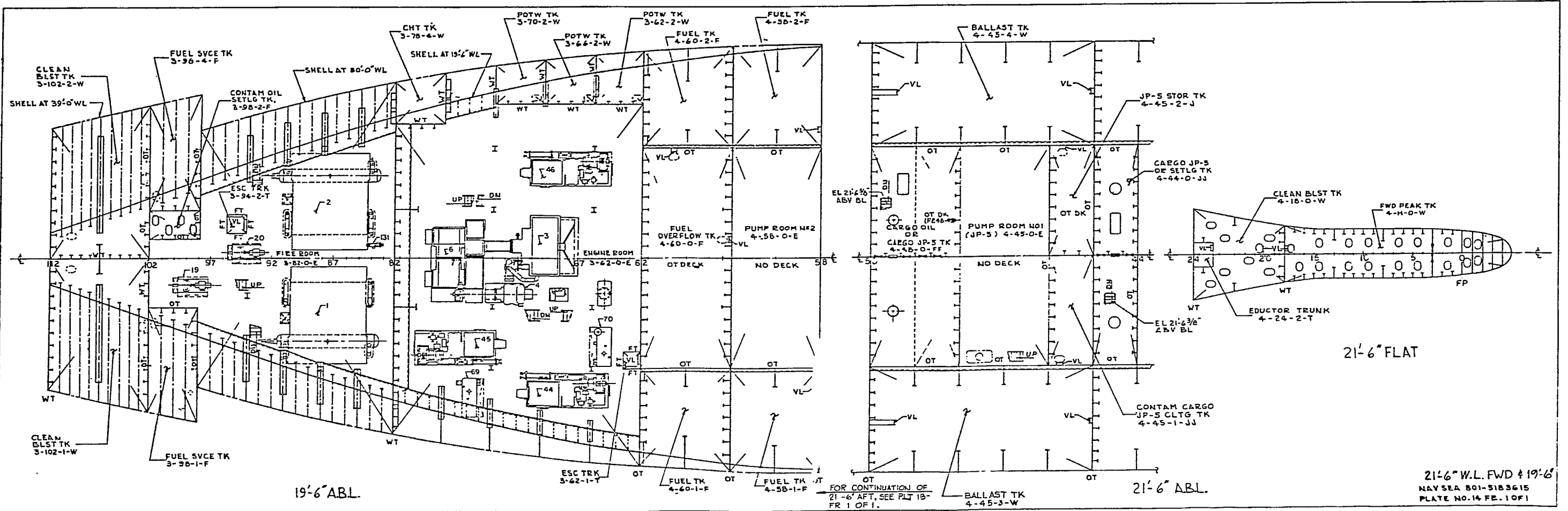

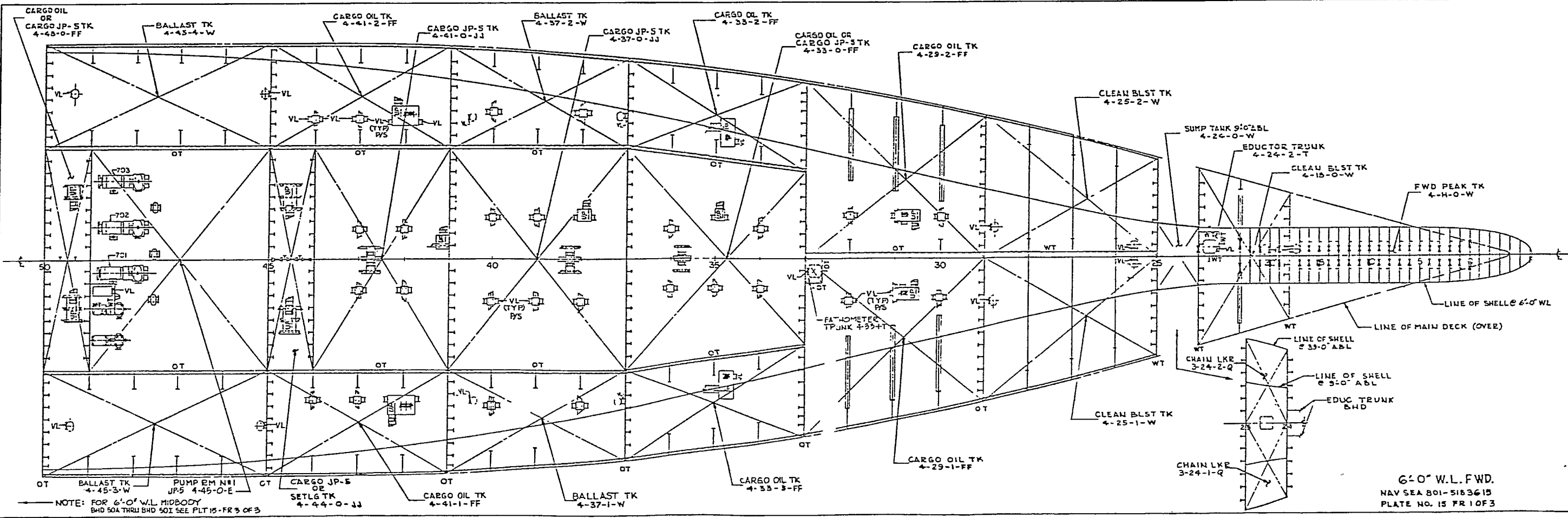

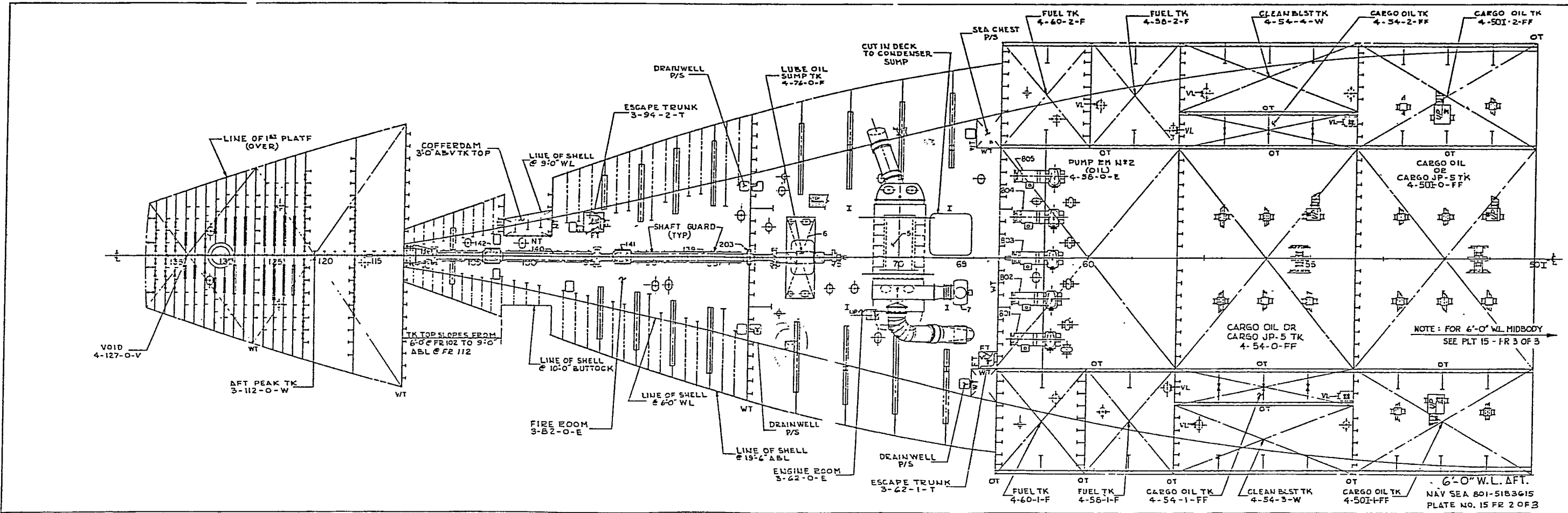

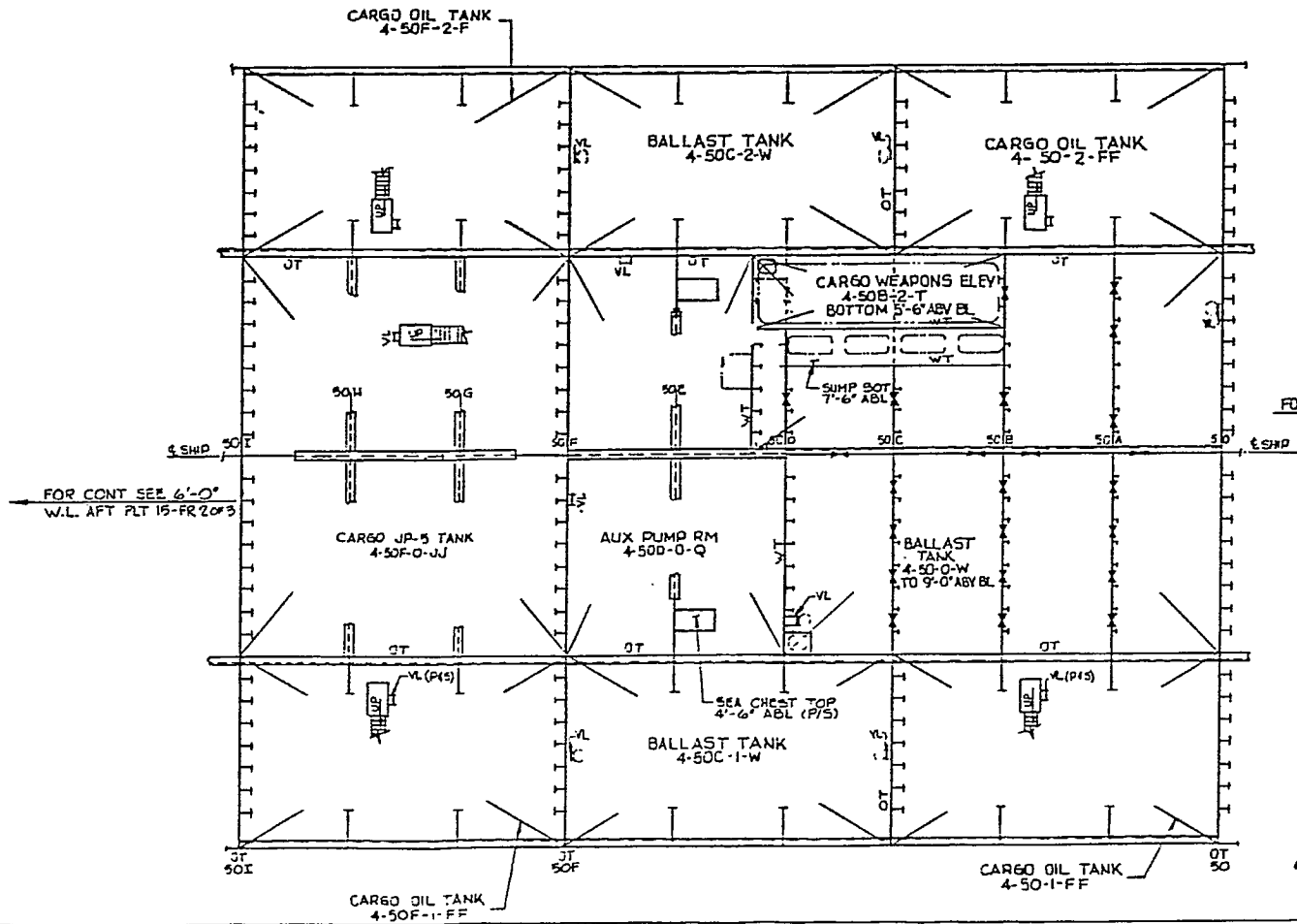
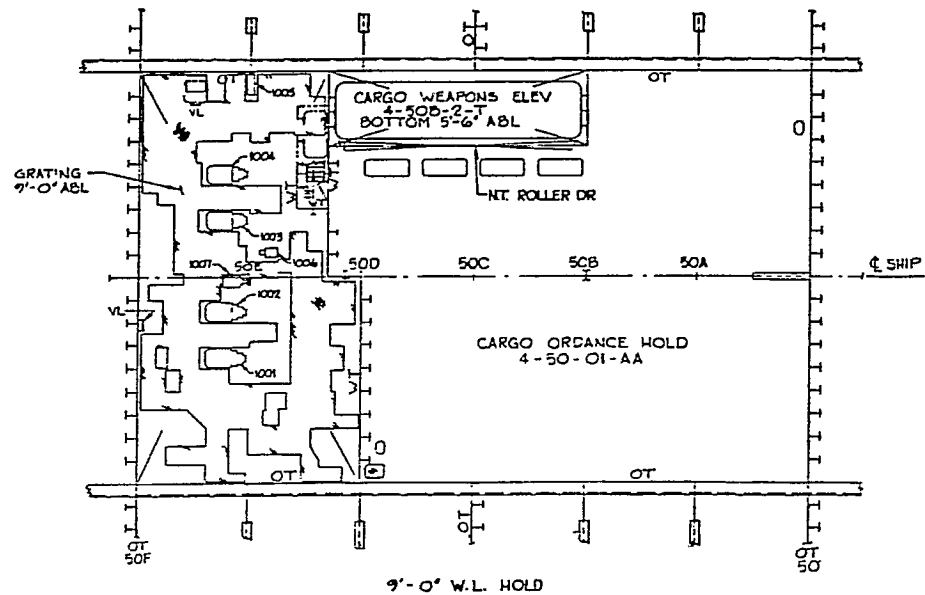

6'-0" W.L. & 9'-0" MIDBODY
NAVSEA 801-5.836-5
PLATE NO. 15-FR 3 OF 3

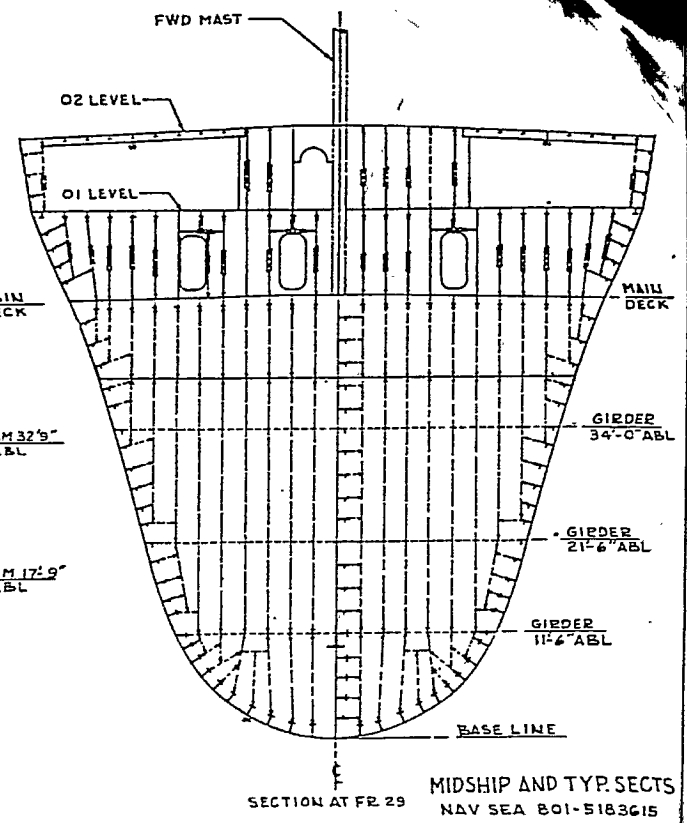
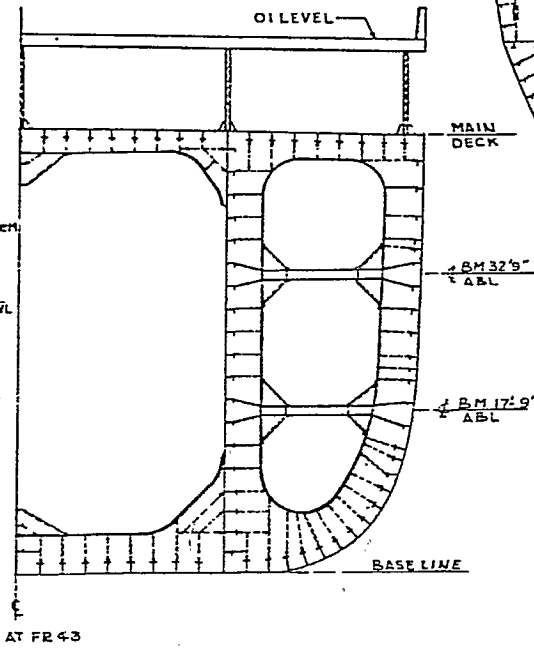
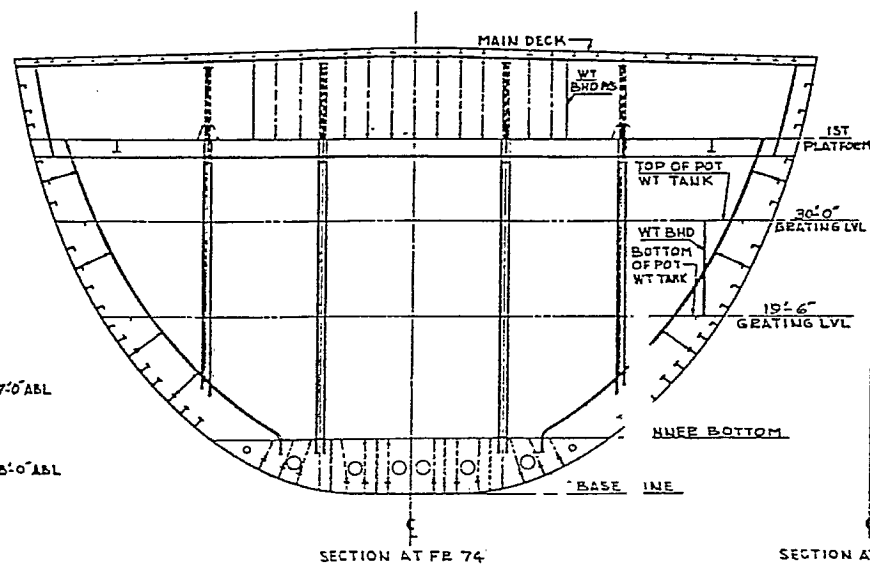
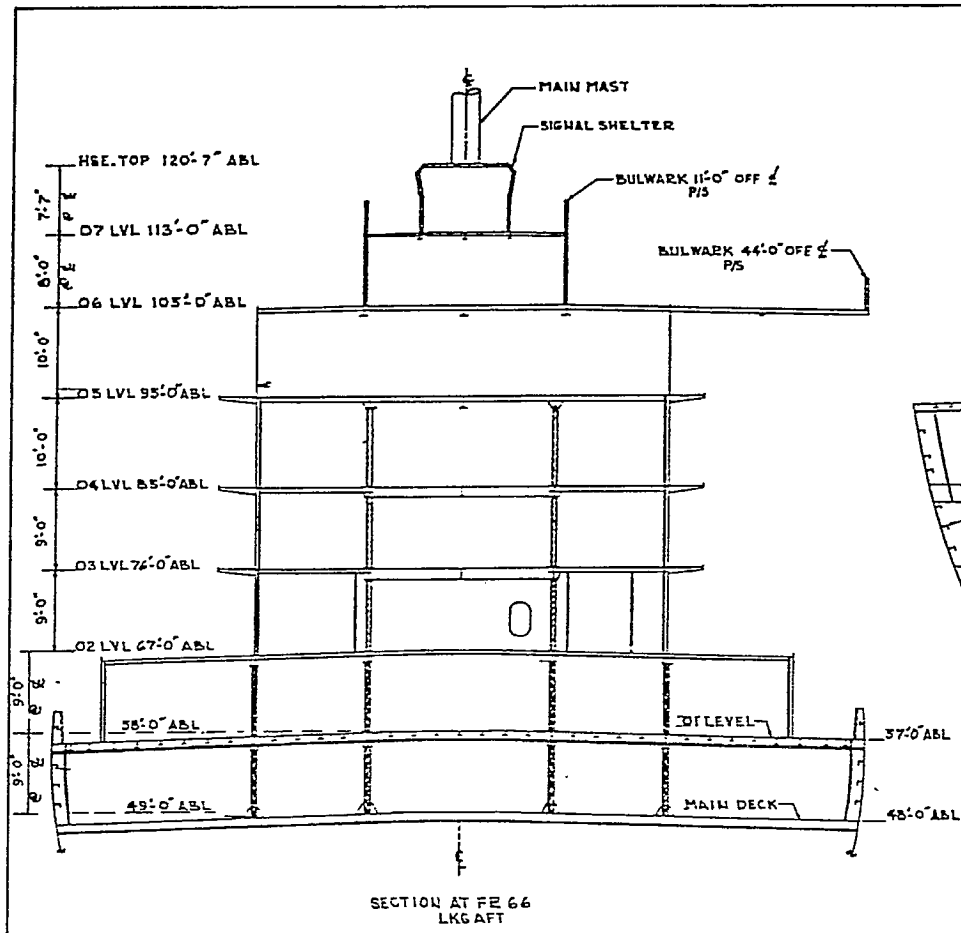

MIDSHIP AND TYP. SECTS
NAV SEA 801-5183G15
PLATE NO: 17 FR 10F1