

BRIDGE DECK 56
ISL Level # 2
Vessel Level 02

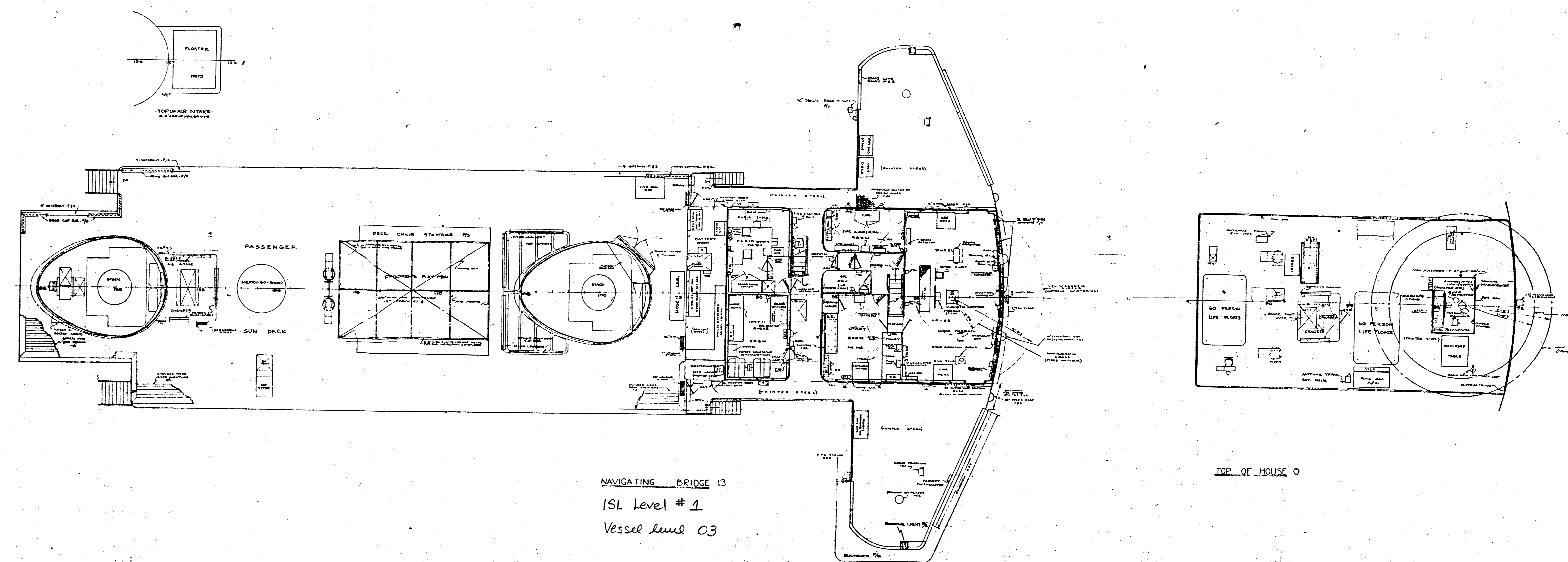

NAVIGATING BRIDGE 13
ISL Level # 1
Vessel Level 03

TOP OF HOUSE 0

NO. _____ ALTERATION _____ BY _____ DATE _____
 THIS PLAN INDICATES A MODIFICATION OF USMC DESIGN TYPE 22-322-80
 DEPARTMENT OF THE NAVY SEATTLE, WA.
 MILITARY SEA TRANSPORTATION SERVICE
 NORPAC SUBAREA

GENERAL ARRANGEMENT
 BOAT DECK # 01
 ISL Level 3

DRAWN _____
 CHECKED T.A. _____
 APPROVED _____
 HEAD TECH SECTION DATE _____
 DATE _____
 APPROVED B _____
 FOR CONSTRUCTION SUBAREA _____
 MSTS PLAN NO. _____

SELECTED RECORD PLAN TAP 121 50103 1085957 ALT. SHEET 1 OF 8

NO. _____ ALTERATION _____ BY _____ DATE _____
 THIS PLAN INDICATES A MODIFICATION OF USMC DESIGN TYPE 22-322-80
 DEPARTMENT OF THE NAVY SEATTLE, WA.
 MILITARY SEA TRANSPORTATION SERVICE
 NORPAC SUBAREA

GENERAL ARRANGEMENT OF
 TOP OF HOUSE
 NAVIGATING BRIDGE # 03 ISL-1
 & BRIDGE DECK # 02 ISL-2
 BRIDGE

DRAWN _____
 CHECKED T.A. _____
 APPROVED _____
 HEAD TECH SECTION DATE _____
 DATE _____
 APPROVED _____
 FOR CONSTRUCTION SUBAREA _____
 MSTS PLAN NO. _____

SELECTED RECORD PLAN TAP 121 50103 1085956 ALT. SHEET 1 OF 8



PROMENADE DECK

PROMENADE DECK

| | | | |
|--|---------------------|-------|--------------|
| NO. | ALTERATION | BY | DATE |
| THIS PLAN INDICATES A MODIFICATION OF USMC DESIGN TYPE P2-51 | | | |
| DEPARTMENT OF THE NAVY MILITARY SEA TRANSPORTATION SERVICE NORPACSUBAREA | | | |
| DRAWN | | | |
| TRACED | | | |
| CHECKED | TR 2AL | | |
| APPROVED | | | |
| READ TECH SECTION DATE | | | |
| COPY NAME ENCL DATE | | | |
| APPROVED | | | DATE |
| MSTS PLAN NO. | | | |
| SELECTED RECORD PLAN | TAP 121 | 50103 | 1085958 |
| | SCALE: 1/8" = 1'-0" | | SHEET 3 OF 3 |

GENERAL ARRANGEMENT
PROMENADE DECK #1
15L level 4



A DECK

| | | | |
|--|------------|-------|-------------|
| NO. | ALTERATION | BY | DATE |
| THIS PLAN INDICATES A MODIFICATION OF USMC DESIGN TYPE P2-51-51 | | | |
| DEPARTMENT OF THE NAVY MILITARY SEA TRANSPORTATION SERVICE NORPACSUBAREA | | | |
| DRAWN | | | |
| TRACED | | | |
| CHECKED | TR 2AL | | |
| APPROVED | | | |
| READ TECH SECTION DATE | | | |
| COPY NAME ENCL DATE | | | |
| APPROVED | | | DATE |
| MSTS PLAN NO. | | | |
| SELECTED RECORD PLAN | TAP 121 | 50103 | 1085959 ALT |

GENERAL ARRANGEMENT OF
"A" DECK #2
15L-5



B' DECK

B' DECK FORD

| | | | |
|---|------------|---------------------------|------|
| NO. | ALTERATION | BY | DATE |
| THIS PLAN INDICATES A MODIFICATION OF USMC DESIGN TYPE P2-552-E1. | | | |
| DEPARTMENT OF THE NAVY | | SEATTLE, WASH. | |
| MILITARY SEA TRANSPORTATION SERVICE | | | |
| NORPAC SUBAREA | | | |
| DRAWN | | GENERAL ARRANGEMENT | |
| TRACED | | B' DECK #3 | |
| CHECKED | DAD | 15L-60 | |
| APPROVED | | DATE | |
| HEAD TECH. SECT. | DATE | APPROVED | |
| SUPT. MARINE ENG. | DATE | FOR COMSTS NORPAC SUBAREA | |
| SELECTED RECORD PLAN | | MSTS PLAN NO. | |
| T-AP121 50103 1085960 ALT. | | SCALE 1/8" = 1'-0" | |
| | | SHEET 5 OF 8 | |



C DECK - AFT.

C DECK FORD

| | | | |
|-------------------------------------|------------------------|----------------|------|
| NO. | ALTERATION | BY | DATE |
| DEPARTMENT OF THE NAVY | | SEATTLE, WASH. | |
| MILITARY SEA TRANSPORTATION SERVICE | | | |
| DRAWN | GENERAL ARRANGEMENT OF | | |
| TRACED | "C" DECK #4 | | |
| CHECKED | ISL-7 | | |
| APPROVED | DATE | | |
| HEAD TECH SECT. DATE | APPROVED | | |
| SUPT. MARINE DATE | DATE | | |
| FOR COMSTS NOE PAC SUBAREA | | | |
| MSTS PLAN NO. | | | |
| TAP 121 | 50103 | 1085961 | ALT |
| SCALE: 1/8" = 1'-0" | | SHEET 6 OF 8 | |



| | | | |
|--|------------|----------------------------|------|
| NO. | ALTERATION | BY | DATE |
| THIS PLAN INDICATES A MODIFICATION OF USMC DESIGN TYPE | | | |
| DEPARTMENT OF THE NAVY | | SEATTLE, WASH. | |
| MILITARY SEA TRANSPORTATION SERVICE | | | |
| NORPACSUBAREA | | | |
| DRAWN | | GENERAL ARRANGEMENT | |
| TRACED | | | |
| CHECKED | J. MATE | | |
| APPROVED | | | |
| HEAD TECH. SECTION | | DATE | |
| APPROVED | | DATE | |
| SUPT. MARINE ENG. | | DATE | |
| FOR COMSTSNORPACSUBAREA | | | |
| SELECTED RECORD PLAN | | MSTS PLAN NO. | |
| U.S.N. GALLEY | | T-AP121 50103 1085962 A1 | |
| SCALE | | SHEET | |

"D" DECK

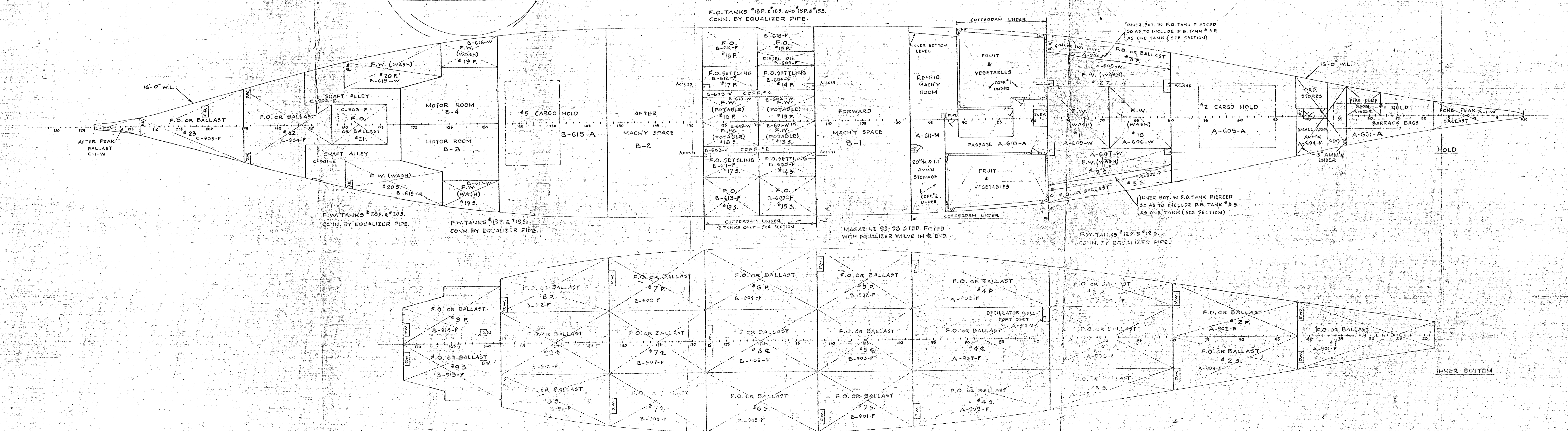
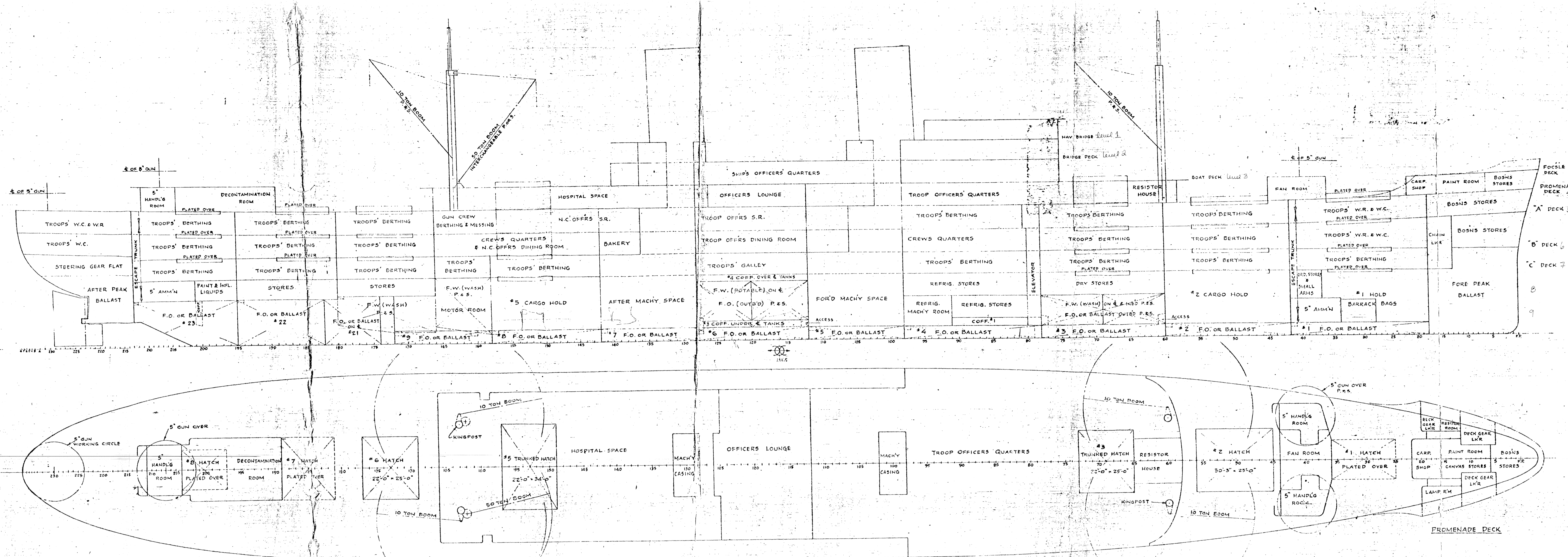
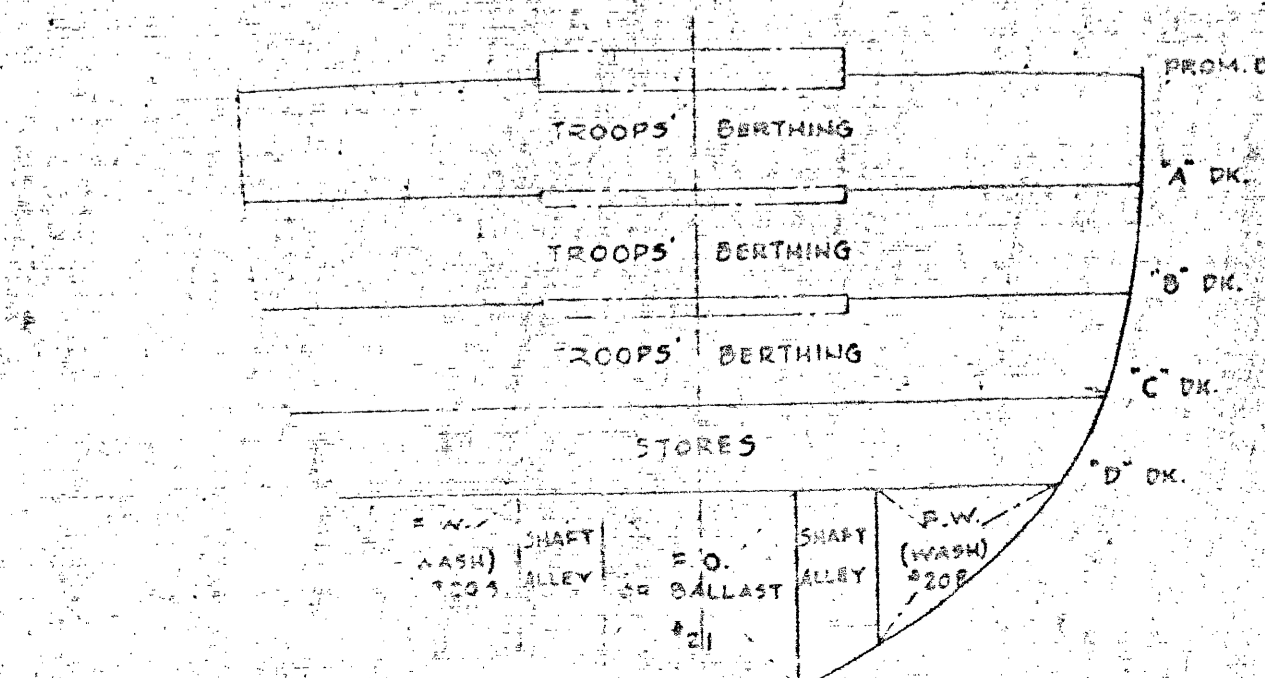
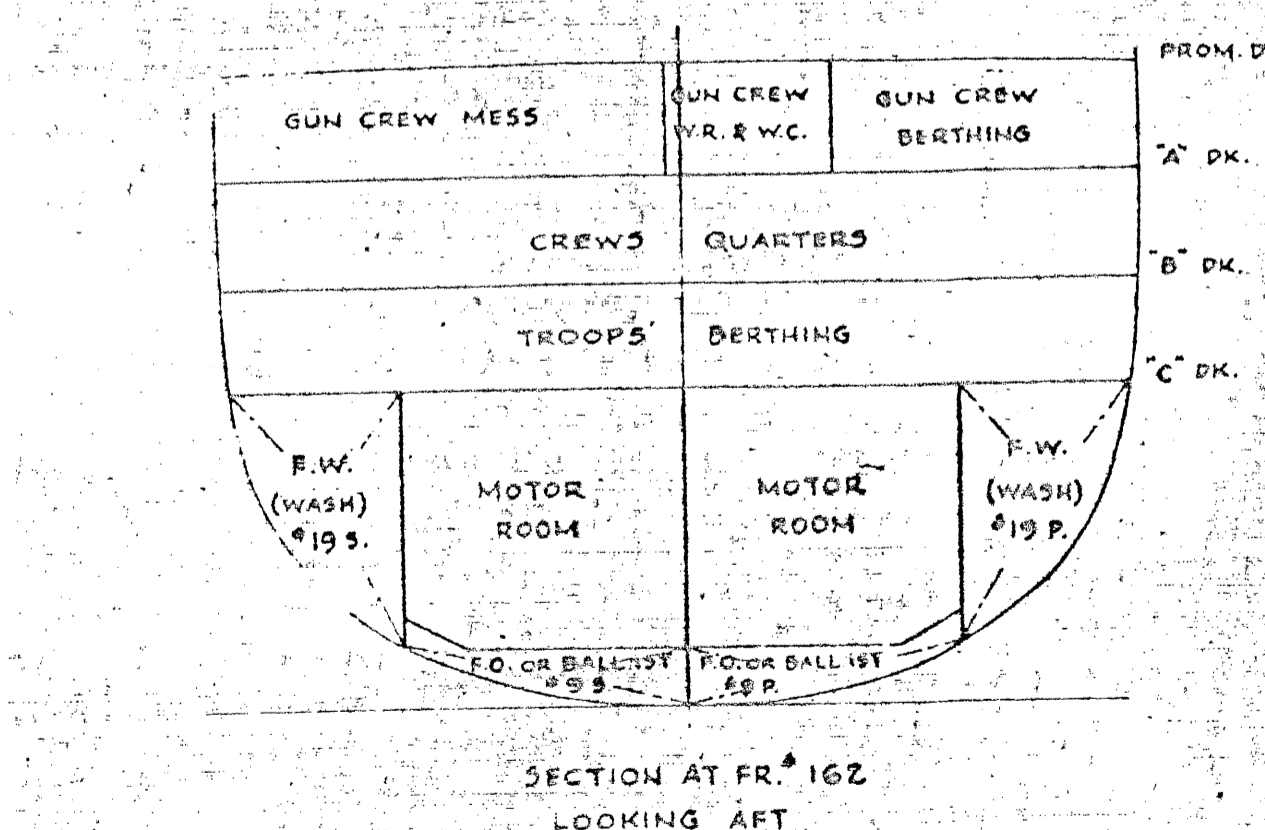
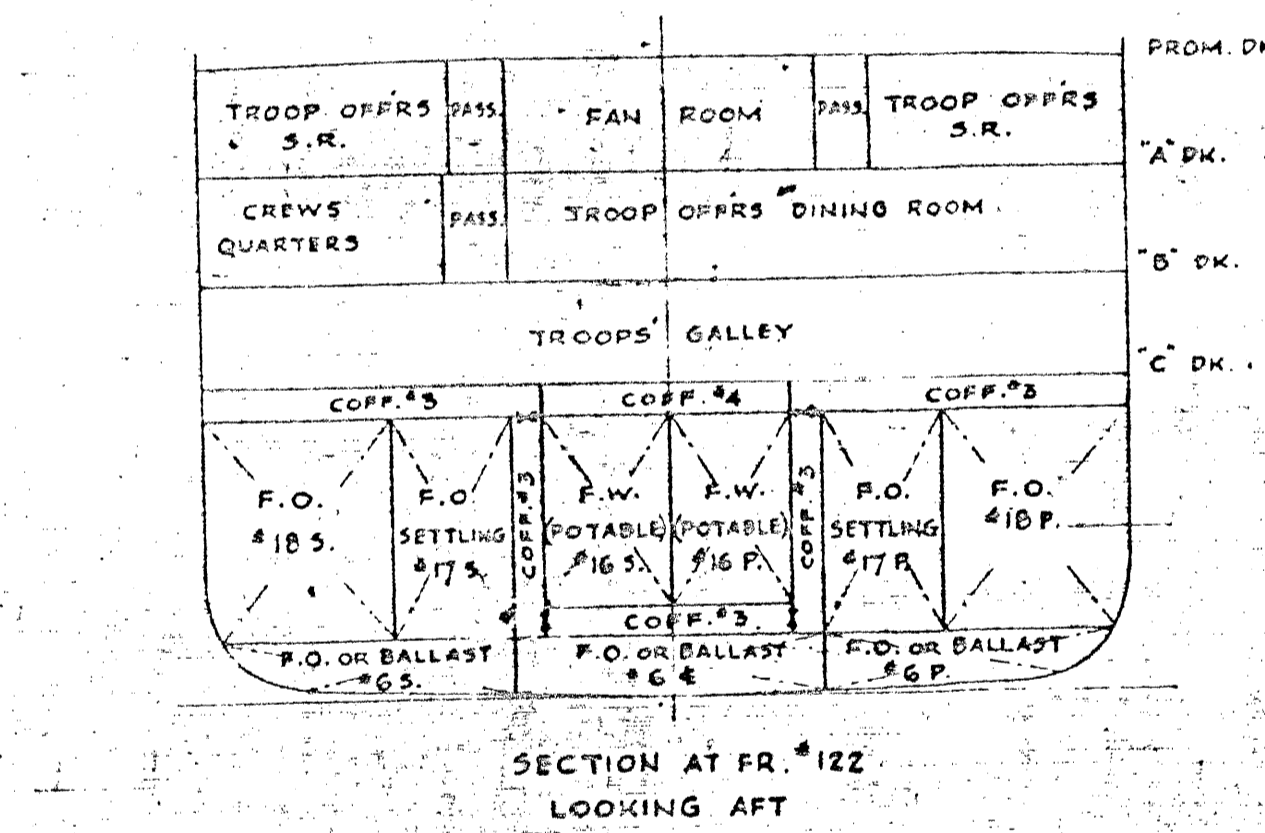
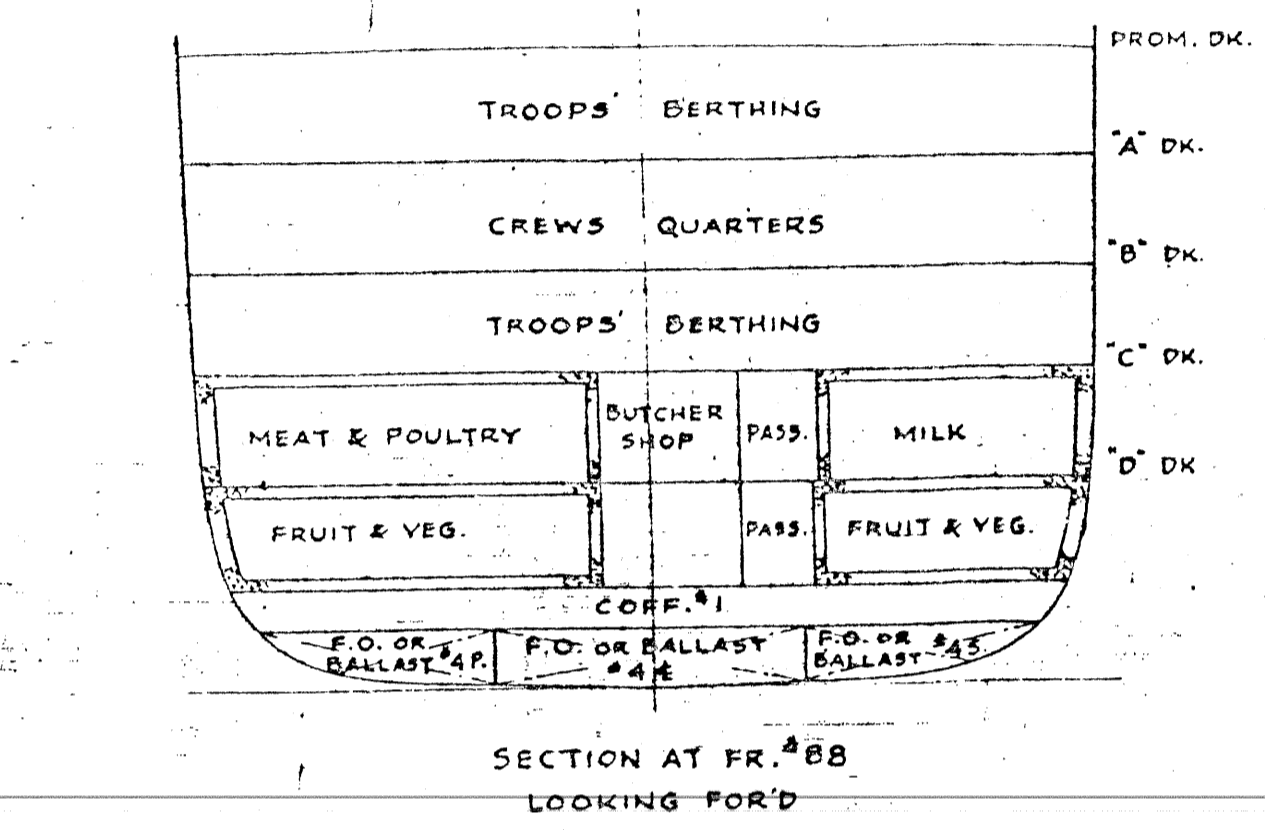
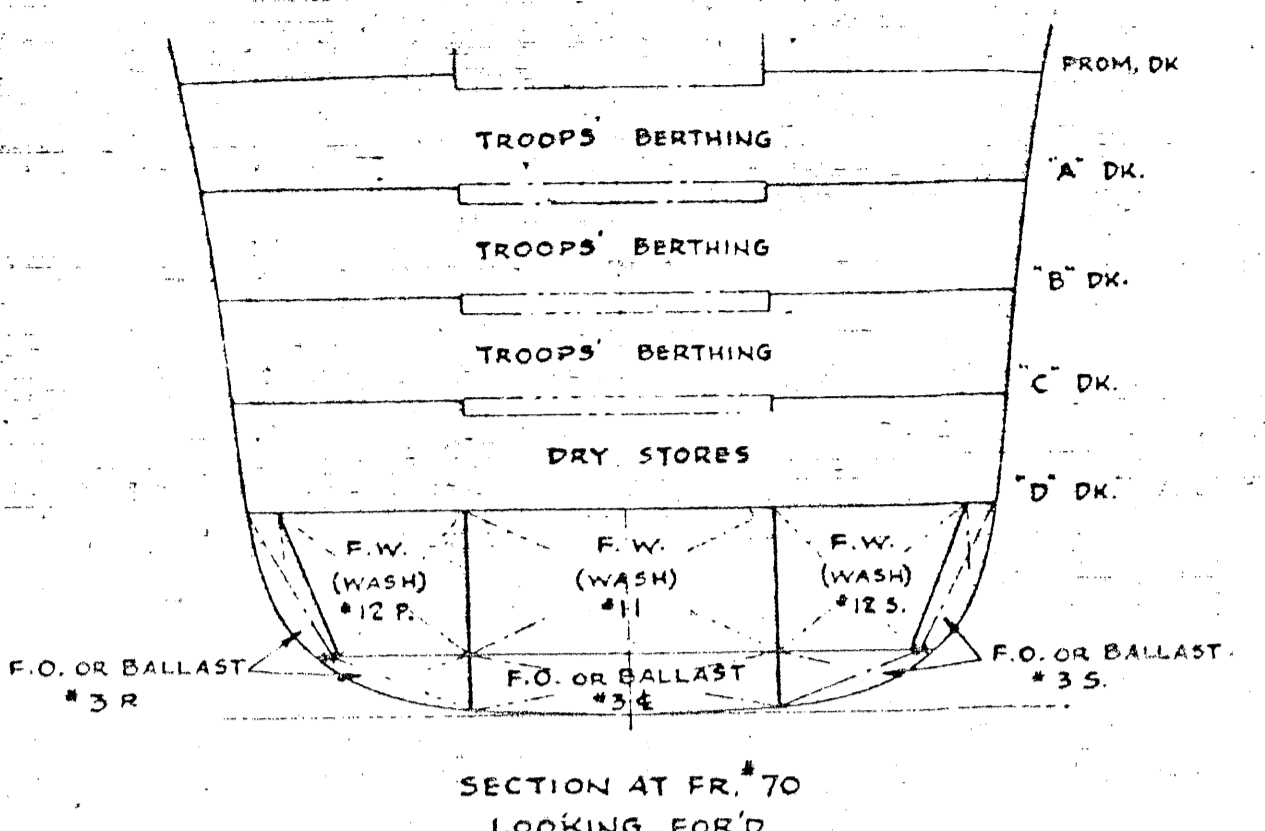

| | | | | |
|----|------------------------------------|----------|-----|--|
| 1 | DATE INDICATED FOR FUEL OIL 4 HOSE | 10/13/41 | 105 | |
| 2 | DATE INDICATED FOR FUEL OIL 4 HOSE | 10/13/41 | 105 | |
| 3 | DATE INDICATED FOR FUEL OIL 4 HOSE | 10/13/41 | 105 | |
| 4 | DATE INDICATED FOR FUEL OIL 4 HOSE | 10/13/41 | 105 | |
| 5 | DATE INDICATED FOR FUEL OIL 4 HOSE | 10/13/41 | 105 | |
| 6 | DATE INDICATED FOR FUEL OIL 4 HOSE | 10/13/41 | 105 | |
| 7 | DATE INDICATED FOR FUEL OIL 4 HOSE | 10/13/41 | 105 | |
| 8 | DATE INDICATED FOR FUEL OIL 4 HOSE | 10/13/41 | 105 | |
| 9 | DATE INDICATED FOR FUEL OIL 4 HOSE | 10/13/41 | 105 | |
| 10 | DATE INDICATED FOR FUEL OIL 4 HOSE | 10/13/41 | 105 | |
| 11 | DATE INDICATED FOR FUEL OIL 4 HOSE | 10/13/41 | 105 | |
| 12 | DATE INDICATED FOR FUEL OIL 4 HOSE | 10/13/41 | 105 | |
| 13 | DATE INDICATED FOR FUEL OIL 4 HOSE | 10/13/41 | 105 | |
| 14 | DATE INDICATED FOR FUEL OIL 4 HOSE | 10/13/41 | 105 | |
| 15 | DATE INDICATED FOR FUEL OIL 4 HOSE | 10/13/41 | 105 | |
| 16 | DATE INDICATED FOR FUEL OIL 4 HOSE | 10/13/41 | 105 | |
| 17 | DATE INDICATED FOR FUEL OIL 4 HOSE | 10/13/41 | 105 | |
| 18 | DATE INDICATED FOR FUEL OIL 4 HOSE | 10/13/41 | 105 | |
| 19 | DATE INDICATED FOR FUEL OIL 4 HOSE | 10/13/41 | 105 | |
| 20 | DATE INDICATED FOR FUEL OIL 4 HOSE | 10/13/41 | 105 | |



THIS PLAN
SUPERSEDES
9501-11-6

PRINCIPAL DIMENSIONS

| | |
|-------------------------------------|----------|
| LENGTH OVERALL | 608' 11" |
| LENGTH ON DESIGNED WATERLINE | 590' 0" |
| LENGTH BETWEEN PERPENDICULARS | 575' 0" |
| BREADTH MOULDED | 75' 6" |
| DEPTH MOULDED TO FROM DECK AT SIDE | 52' 6" |
| DRAFT MOULDED TO DESIGNED WATERLINE | 29' 2" |

| | | | | |
|---------------|--------------------------|-------------|-------|------------|
| DESIGN NO. | 9503 | G80 | P.122 | RE. COONTZ |
| DESIGN NO. | 9502 | G79 | P.121 | WL. CAFFS |
| DESIGN NO. | 9501 | G78 | P.120 | WS. DENSON |
| YARD HULL NO. | M.C. NO. | WORKING NO. | NAME | |
| DESIGN P2-5E2 | U.S. MARITIME COMMISSION | | | |

OUTBOARD PROFILE

SCALE: 1/8" = 1 FOOT

DATE: 11-10-41

DRAWN BY: J.A. 228

CHECKED BY: J.A. 228

APPROVED BY: [Signature]

BE THE CHEMISTS PL. CO. SHIPBUILDING DIV.
FOUR P. VER YARD
QUINCY, MASS.
HULL DEPARTMENT

JOBS: PLAN No 9501-11-6-1

U.S. MARITIME COMMISSION

APPROVED AS NOTED BY

M. C. LETTER DATED 10-22-41

M. C. FILE NO. 9503

BY: [Signature]

LIST OF PERSONNEL

| DECK | NAVY | | | | ARMY | | | | CG BAY |
|--------|----------|----------|------|------------------|----------|--------|--------|-----|--------|
| | OFFICERS | ENLISTED | CREW | MEN'S ATTENDANTS | OFFICERS | N.C.O. | TROOPS | | |
| BRIDGE | 1 | | | | | | | | |
| BOAT | 36 | | | | 36 | | | | |
| PROM | | | | | 280 | | | 116 | CG |
| A | | | | | 171 | | 1215 | | |
| B | 30 | 368 | 32 | | | | 1073 | | |
| C | | | | | | | 2277 | | |
| TOTAL | 67 | 30 | 368 | 32 | 316 | 171 | 4679 | | CG |