

KOMMANDOBRÜCKE

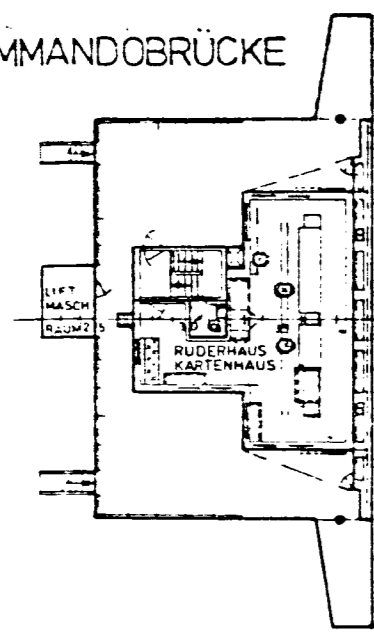

E-DECK

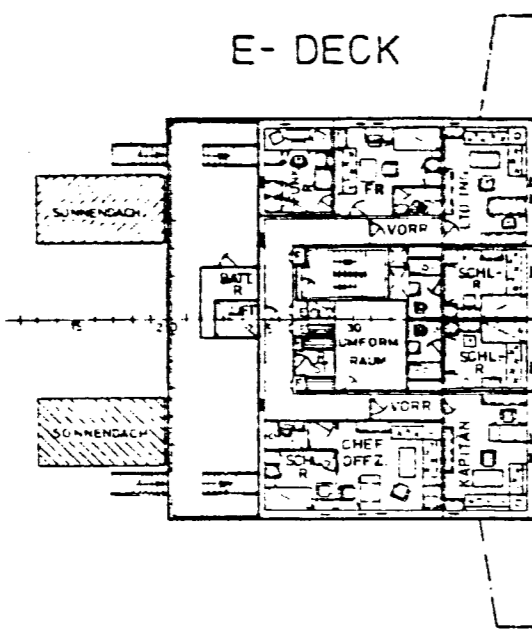

D-DECK

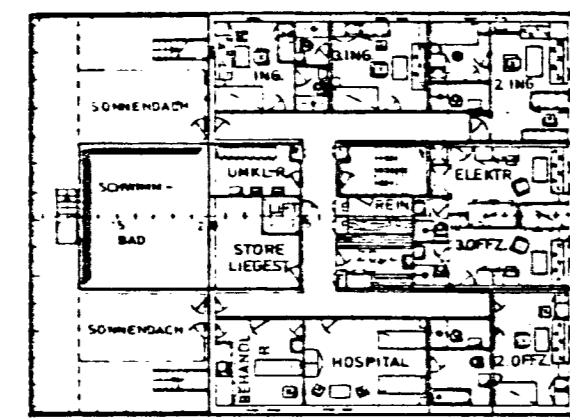

C-DECK

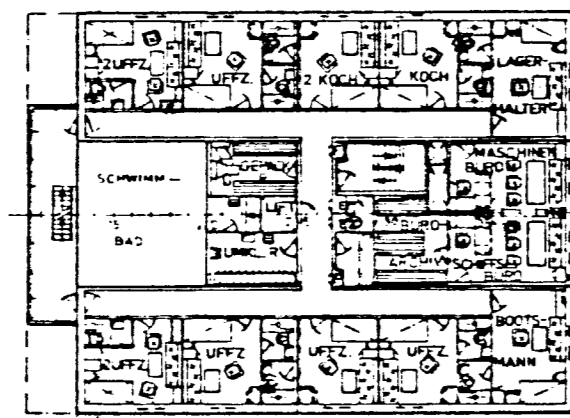

B-DECK

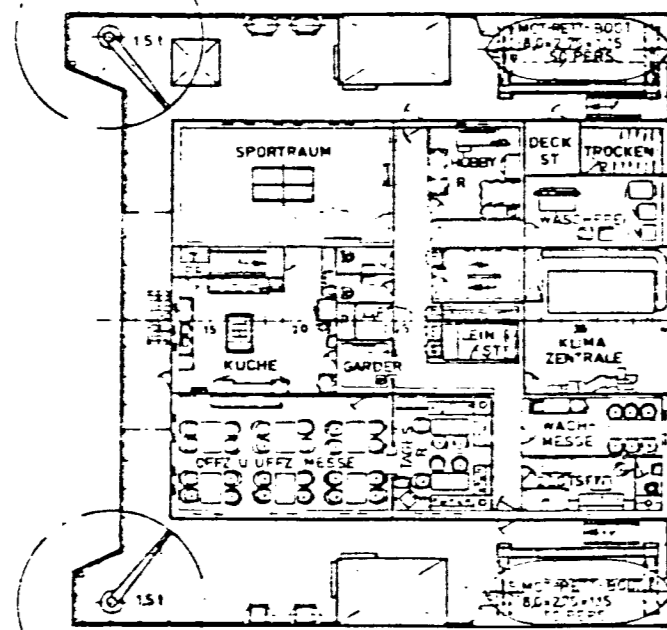

A-DECK

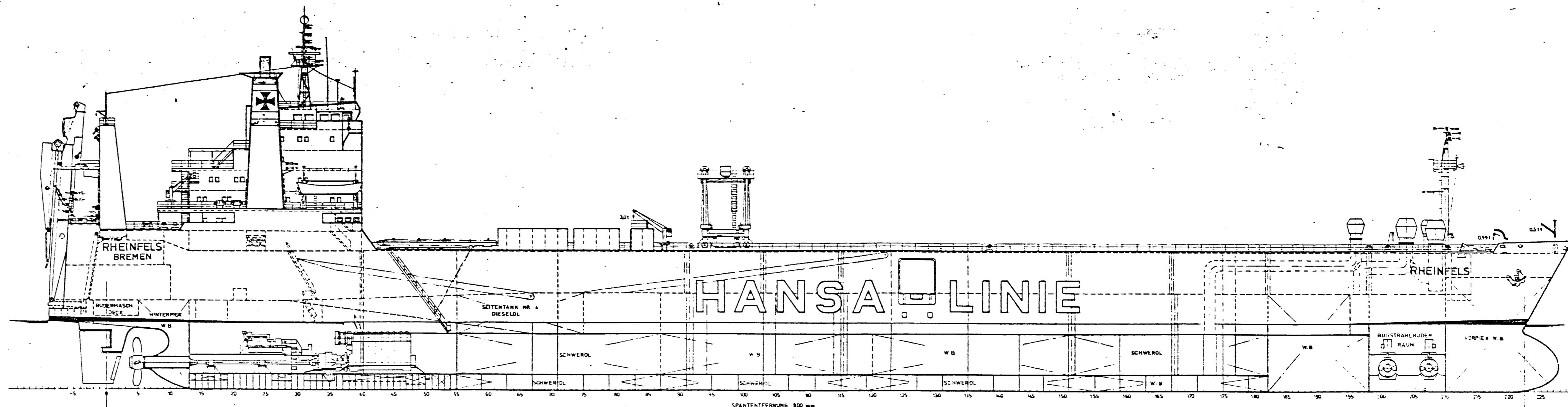
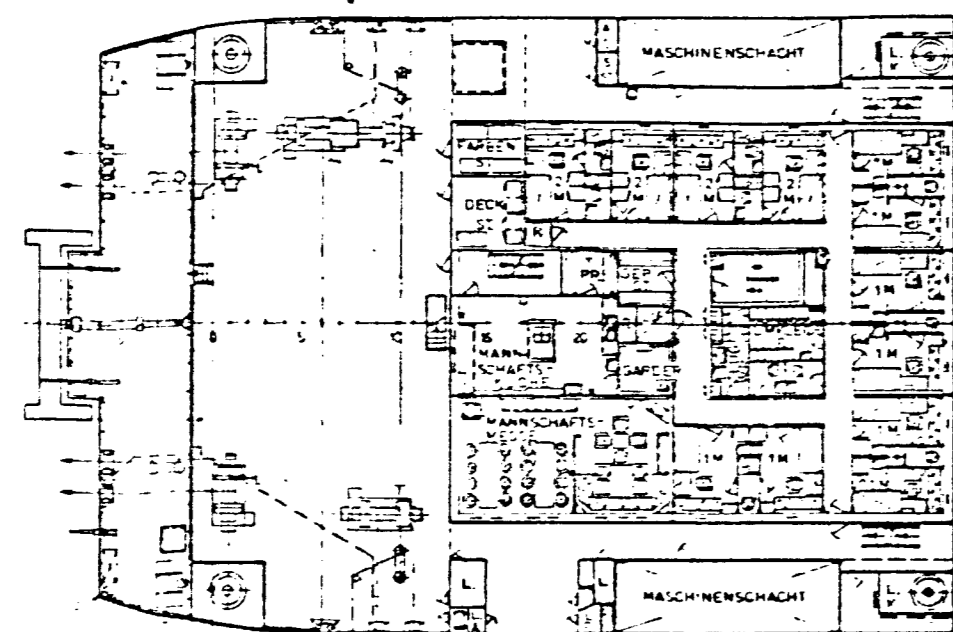

1. DECK (OBERDECK)

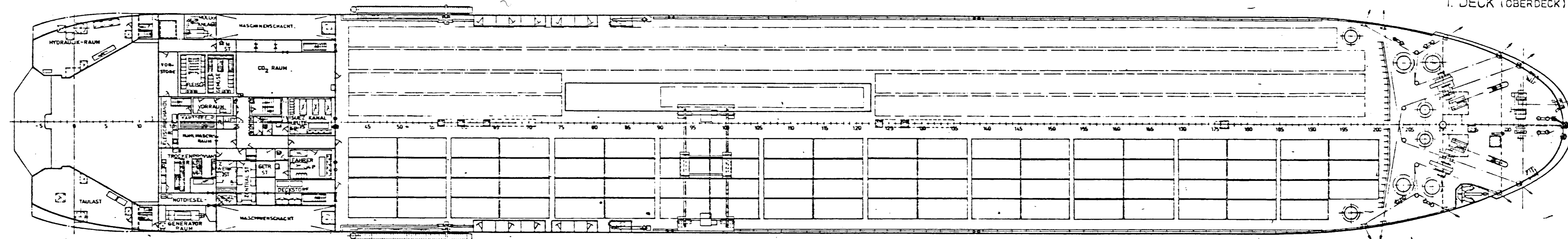

1. DECK (OBERDECK)

2. DECK

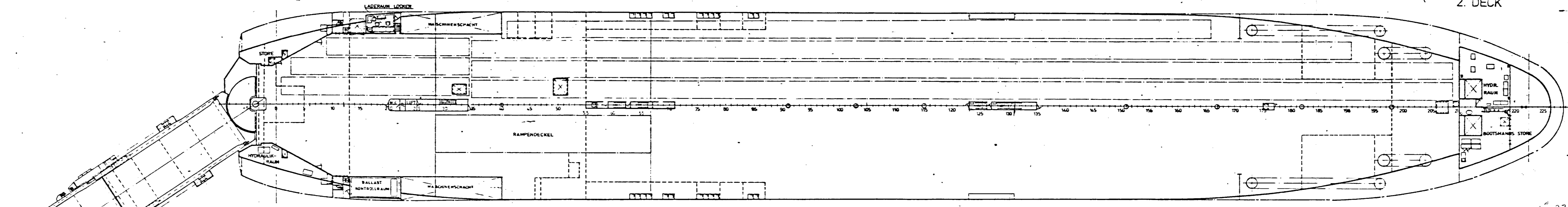

2. DECK

3. DECK

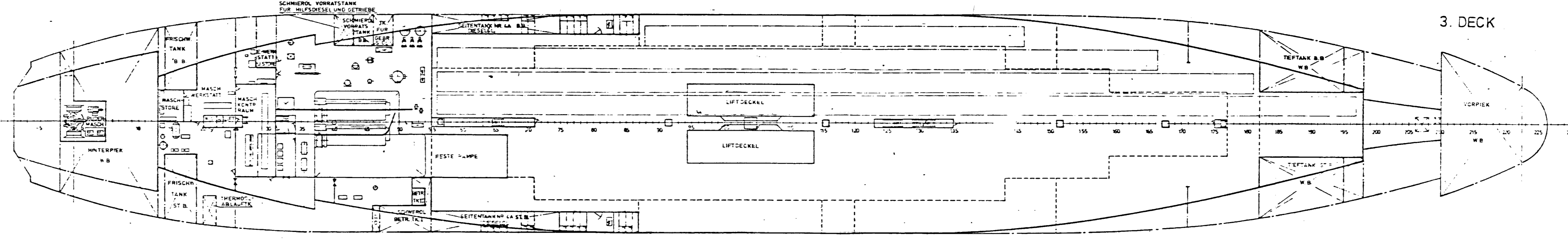

3. DECK

INNENBODEN

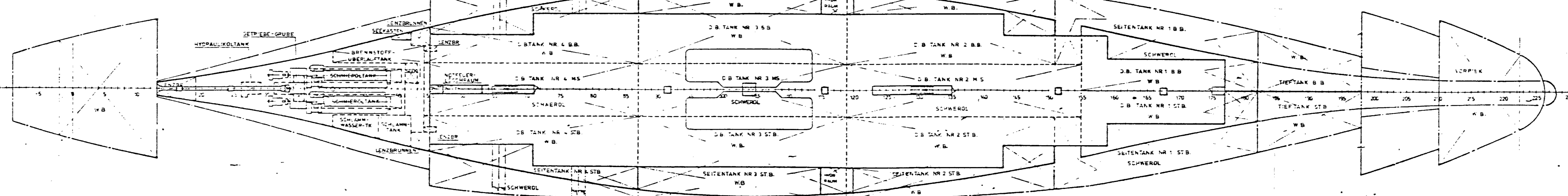

INNENBODEN

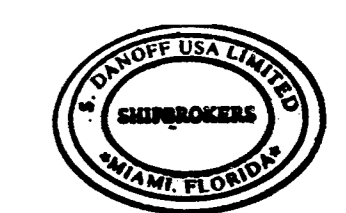
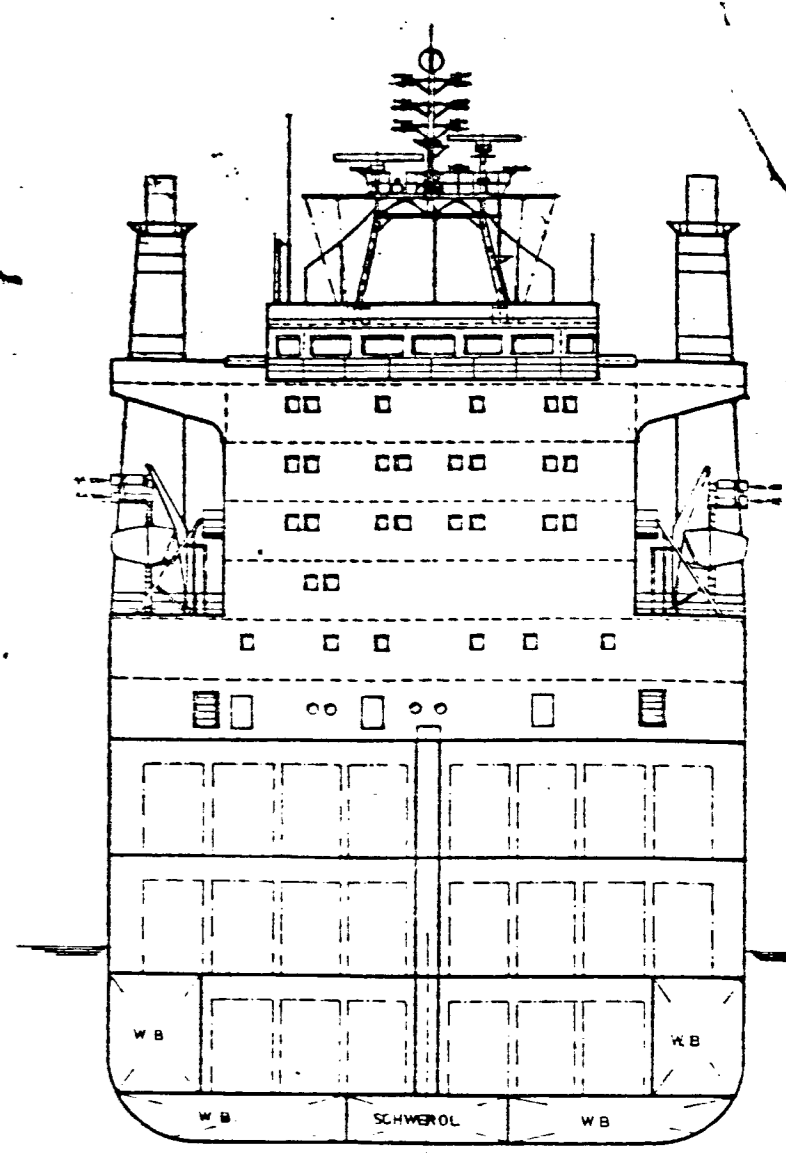

ROLL-ON / ROLL-OFF SCHIFF

N/Y "SANTOS"

HAUPTDATEN:

LÄNGE ÜBER ALLES 193,320m

LÄNGE ZWISCHEN DEN LÖTEN 178,000m

BREITE AUF SPANTEN 27,000m

SEITENHÖHE 17,600m

TRIEFDANG 8,614m

TRAGFÄHIGKEIT (T=8,614m) 15.075 t

MOTORENLEISTUNG 2 x 9495 PS

GESCHWINDIGKEIT 20,0 Kn

bei T=8,614m u. 15000 PS (am PROP)

GENERALPLAN

M 1:250

HAWALDTSWERKE - DEUTSCHE WERFT
AKTIENGESELLSCHAFT, HAMBURG UND KIEL
WERK KIEL

SAU NR. 113 ZEICHNUNG NR. 0290 0002

KIEL DEN 29. NOVEMBER 1967